

HANBANG

回转驱动
SLEWING DRIVE

HANBANG

徐州汉邦回转支承有限公司

XUZHOU HANBANG SLEWING BEARING CO.,LTD

地址: 江苏省徐州城北时代大道
电话: 0516 -87726238
传真: 0516 -85882678
邮箱: sales@xzhbhzzc.com
网址: www.xzhbhzzc.com

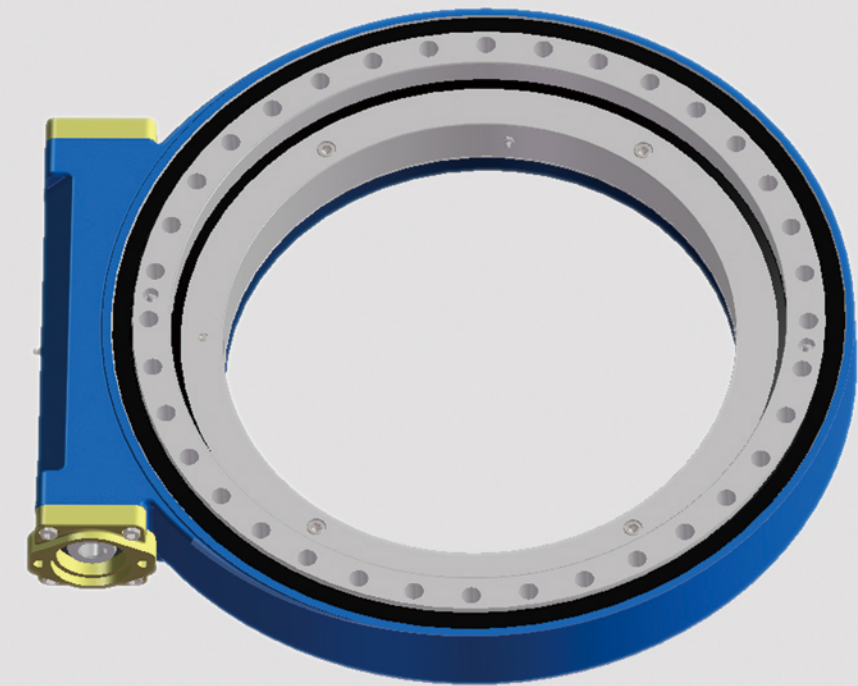

徐州汉邦回转支承有限公司

XUZHOU HANBANG SLEWING BEARING CO.,LTD

公司简介

Company Profile

徐州汉邦回转支承有限公司是一家集生产研发,技术支持、营销服务为一体的企业,我们主营齿轮与涡轮类回转式减速器、回转支承、及其他非标的零部件技术服务与营销。公司经营的传动产品主要应用于新能源光伏与光热的应用领域(双轴光伏,斜单轴、平单轴光伏跟踪系统、联动光伏系统、光热槽式集热系统、光热塔式聚光系统、光热线性菲涅尔系统、光热蝶式发电系统及大小型风力发电应用),及工程机械(道路机械、港口设备、矿山机械、工程车辆、液压与电动机械属具、自动化设备、卫星接收系统)等领域。

我们专注于齿轮及涡轮类回转驱动的生产研发、技术营销为一体的集成式服务理念,我们秉承坚定信念、专业执着、精益求精、服务至上的企业精神,目前已研发出多种高规格可靠性产品。我们以专向定制为设计理念,不断推陈出新,以此满足各种不同形式的客户需求,凭以高质量的产品与优质的服务为一如既往的为国内外新老用户陆续提供一站式服务。

Xuzhou HANBANG Slewing Bearing Co., Ltd. is an enterprise integrating production, R & D, technical support and marketing services. We are mainly engaged in technical services and marketing of gear and turbine rotary reducers, slewing bearings and other non-standard parts. The transmission products of the company are mainly used in the application fields of new energy photovoltaic and photothermal (biaxial photovoltaic, Inclined single axis, flat single axis photovoltaic tracking system, linkage photovoltaic system, solar thermal trough collector system, solar thermal tower concentrator system, solar thermal linear Fresnel system, solar thermal butterfly power generation system and large and small wind power generation application), and engineering machinery (road machinery, port equipment, mining machinery, engineering vehicles, hydraulic and electric machinery accessories, automation equipment, satellite receiving system)) And so on.

We focus on the gear and turbine rotary drive production research and development, technology marketing as one of the integrated service concept, we uphold the firm belief, professional dedication, excellence, service-oriented enterprise spirit, has developed a variety of high-quality reliability products. With the design concept of special customization, we constantly bring forth new products to meet the needs of different forms of customers. With high-quality products and high-quality services, we continue to provide one-stop service for new and old users at home and abroad.



编码说明 Code Description

Model Code 型号	Gear 齿轮信息	Worm Shaft 蜗杆信息	Motor 马达信息
SE 14 A	85 I	B H 2 R	200 A
<p>A or None — Away (oil port) 油口在外侧 I — Inside (oil port) 油口在内侧 U — Up (oil port) 油口在上方 D — Down (oil port) 油口在下方</p> <p>200 — Hydraulic motor's displacement, cc/r (by design, such as "200") 液压马达排量</p> <p>R — Hydraulic motor position, right side 液压马达位置在右侧 L — Hydraulic motor position, left side 液压马达位置在左侧</p> <p>None — Shaft number, None meaning is only one worm 蜗杆数量, 未注表示为一根蜗杆 2 — dual worm drive 表示为 2 根蜗杆传动</p> <p>None — Shaft opposite to motor, capped end 蜗杆非输入端为闷盖 H — Worm hex extrusion 蜗杆非输入端为六角凸出 E — Shaft opposite to motor, with encoder 蜗杆非输入端为编码器</p> <p>None — Omitted with hydraulic motor 配液压马达时省略 B — SAE 6B spline 蜗杆输入孔为 SAE 6B 花键 12 — 12mm keyed shaft 蜗杆输入孔为 $\phi 12$ 16 — 16mm keyed shaft 蜗杆输入孔为 $\phi 16$ 25 — 25mm keyed shaft 蜗杆输入孔为 $\phi 25$</p> <p>None — The Mounting Hole, Metric 安装螺纹为公制 I — The Mounting Hole, Inch 安装螺纹为英制</p> <p>85 — Ratio 减速比</p> <p>None — General Precision 普通精度 A — Accuracy Grade: A 精度等级为 A B — Accuracy Grade: B 精度等级为 B C — Accuracy Grade: C 精度等级为 C</p> <p>Diameter Of Raceway In Inch 滚道中心直径近似英制尺寸</p> <p>S — Open housing slewing drive 敞开型回转驱动 SE — Enclosed housing slewing drive 围栏型回转驱动 WE — Worm gear slewing drive 涡轮型回转驱动 VE — Vertical slewing drive 立式回转驱动 SDE — Combined slewing drive 组合式回转驱动</p>			

驱动源选配 Driver Source Matching

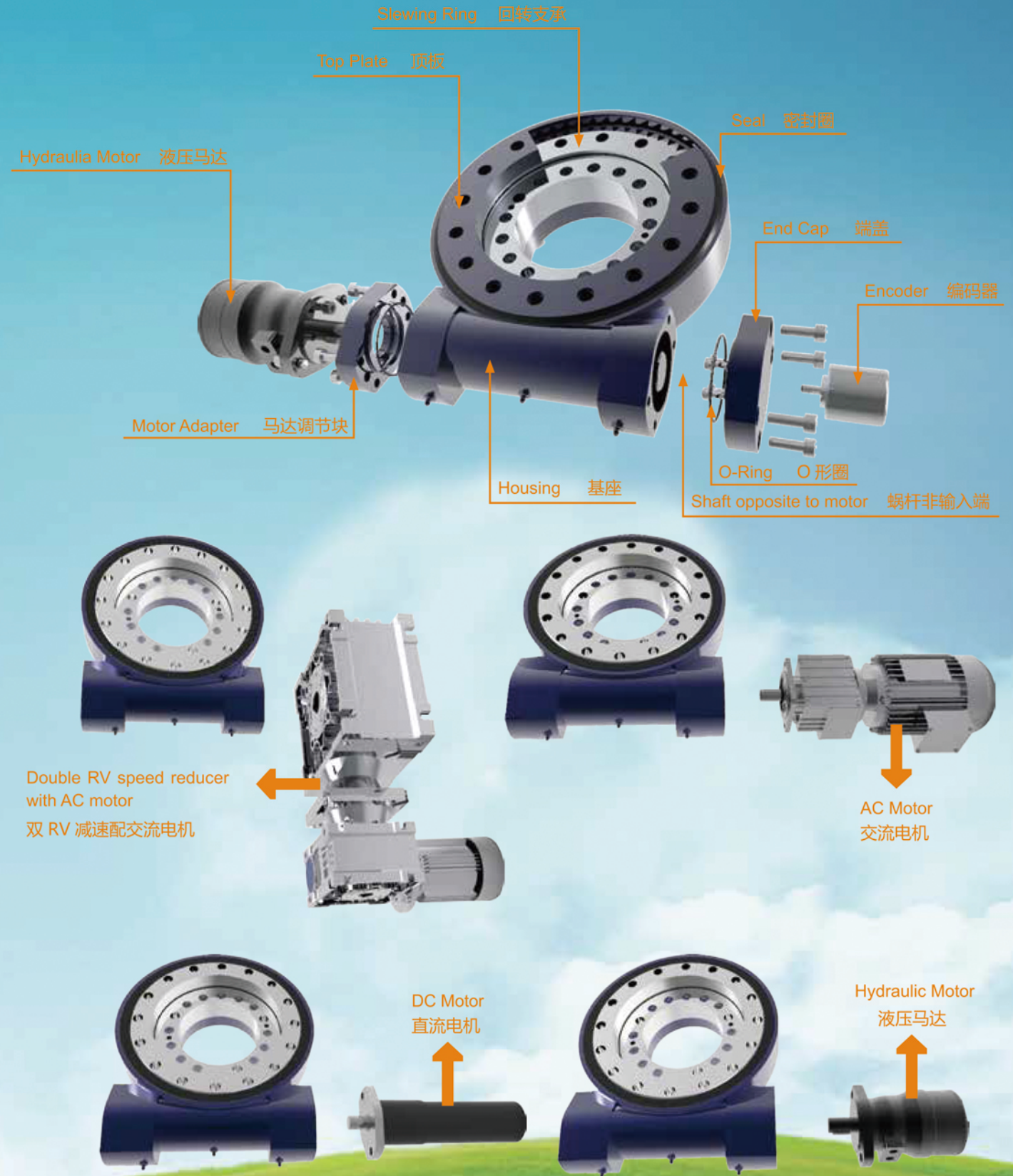

产品应用 — 新能源



槽式太阳能跟踪
Parabolic Trough Solar Tracker



碟式集热系统
Solar Dish Thermal Power



光热塔式跟踪系统
Tower Solar-Thermal System



线性菲涅尔
CSP Linear Fresnel System



CPV 双轴聚光
Dual Axis CPV Solar Tracker



联动式光伏跟踪
Linkage Type PV Tracking



光伏双轴跟踪
Dual Axis PV Solar Tracking



平单轴光伏跟踪
Horizontal Single Axis PV Solar Tracking



风能
Wind Energy



斜单轴跟踪
Inclined Single Axis Solar Tracking



风光互补系统
Wind-Solar Hybrid System

产品应用 — 工程机械



随车吊
Truck Mounted Crane



高空作业车
Aerial Working Platform



爪机属具
Timber Grab

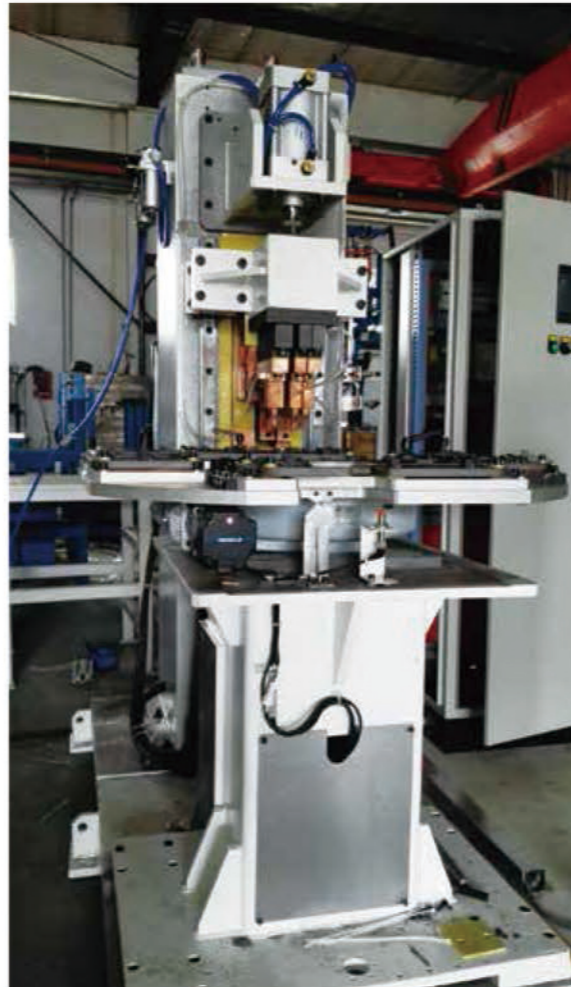

焊接变位机
Welding Positioner



喷雾器
Sprayer



潜孔钻机
Down-Hole Drilling



自动化流水线
Automated Assembly Line



擦窗机
Window Cleaning Machine



液压模块车
Hydraulic Module Car



港口吊车
Marine Crane



液压凿岩钻机
Hydraulic Drilling Rig

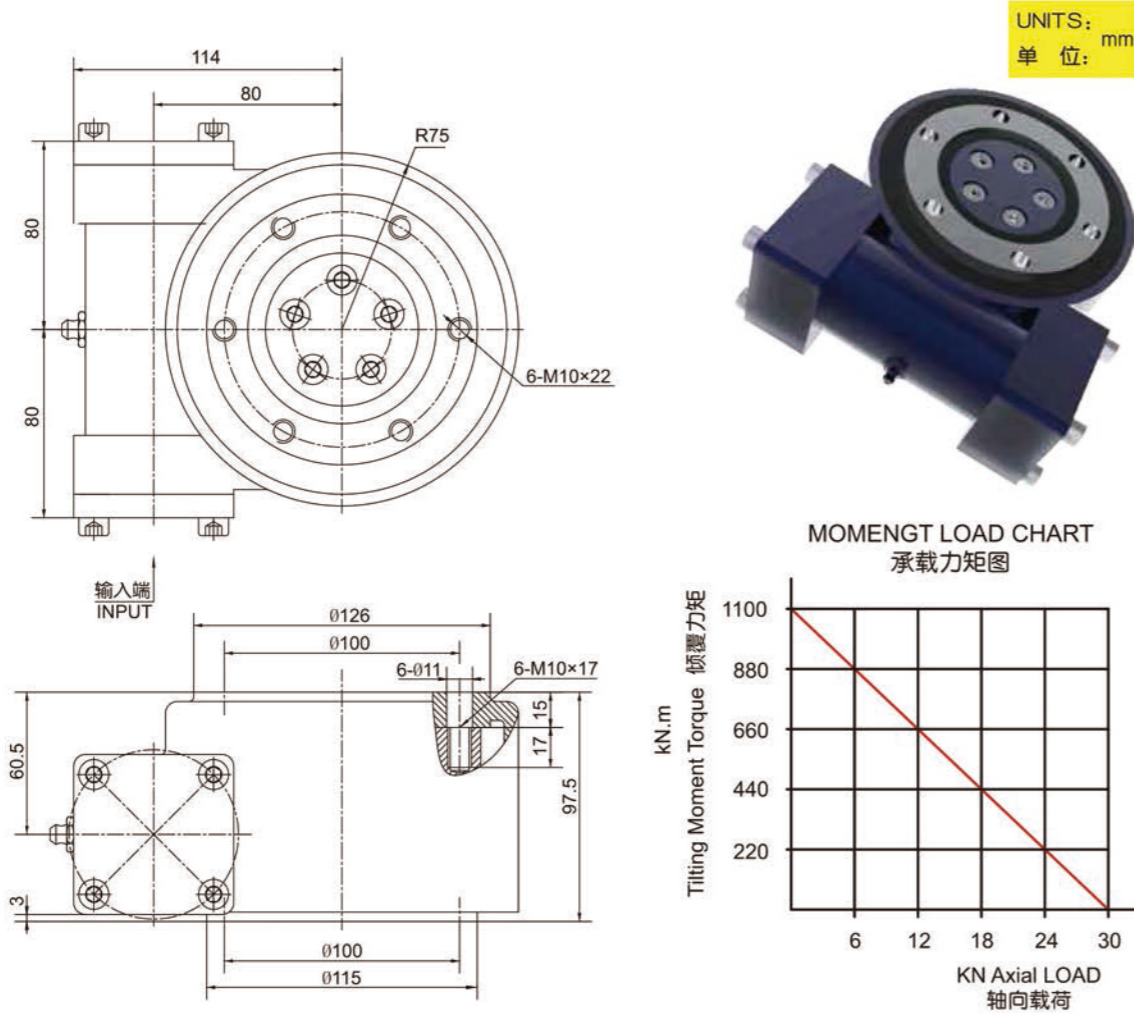

注意 Precautions: 蜗杆两端可根据客户要求进行非标准设计 “A、B” VIEW CUSTOMIZED ACCORDING TO REQUESTS

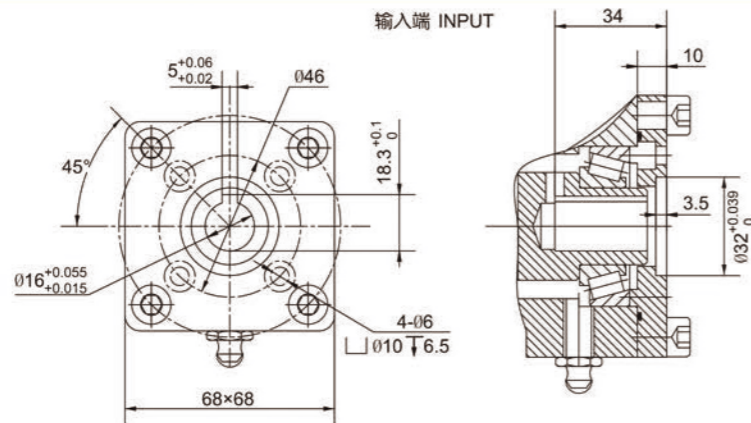

回转驱动性能参数表 Slewing Drive Performance Parameters

SE3	400 N.m	1100 N.m	2000 N.m	30 KN	16.6 KN	9.6 KN	8.4 KN	62 : 1	≤ 0.2°	40%	12kg
	Output Torque 输出扭矩	Tilting Moment Torque 倾覆力矩	Holding Torque 保持力矩	Static Axial Rating 轴向静载荷	Static Radial Rating 径向静载荷	Dynamic Axial Rating 轴向动载荷	Dynamic Radial Rating 径向动载荷	Gear Ratio 减速比	Accuracy 精度	Efficiency 机械效率	Weight 重量

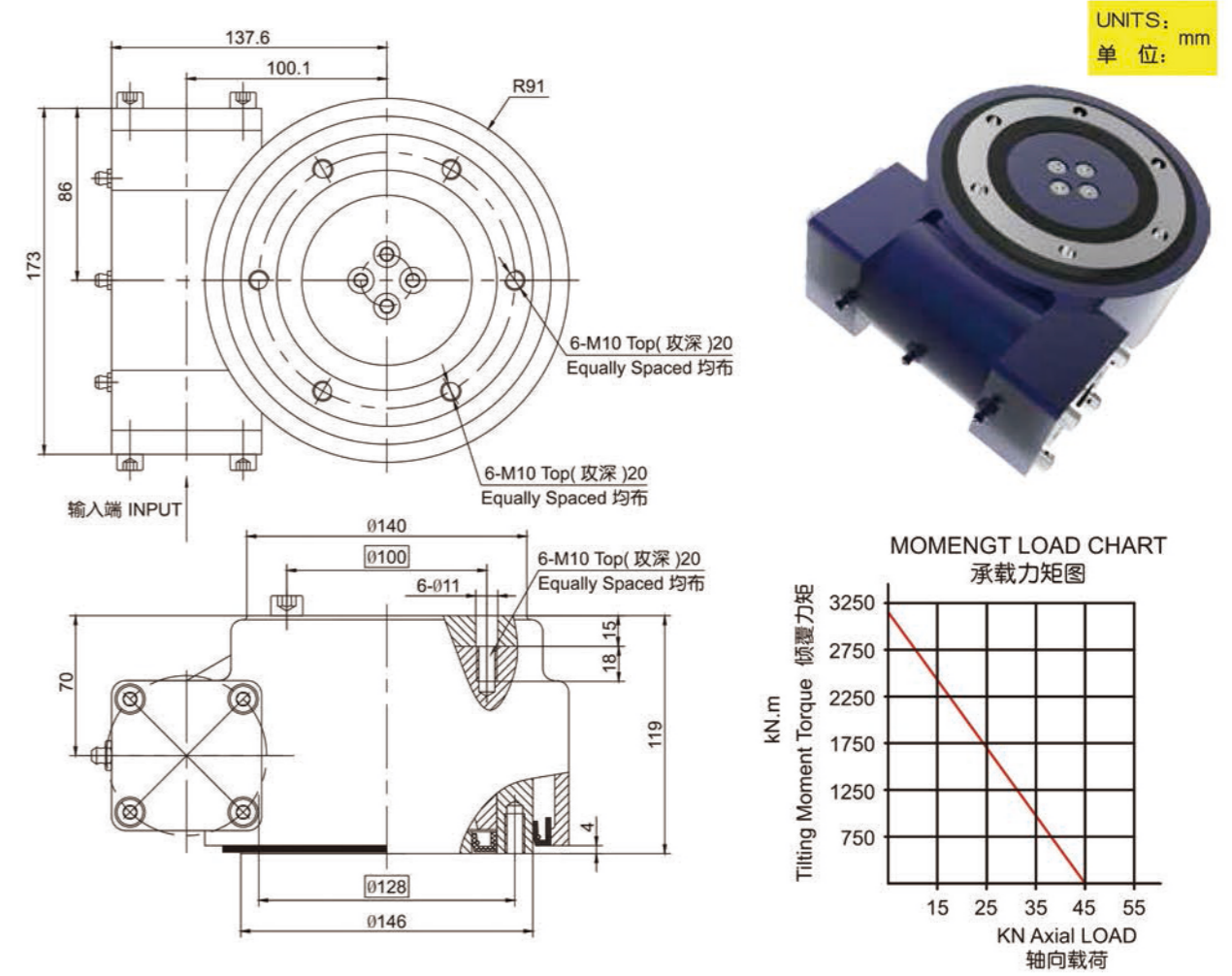

注意 Precautions: 蜗杆两端可根据客户要求进行非标准设计 “A、B” VIEW CUSTOMIZED ACCORDING TO REQUESTS

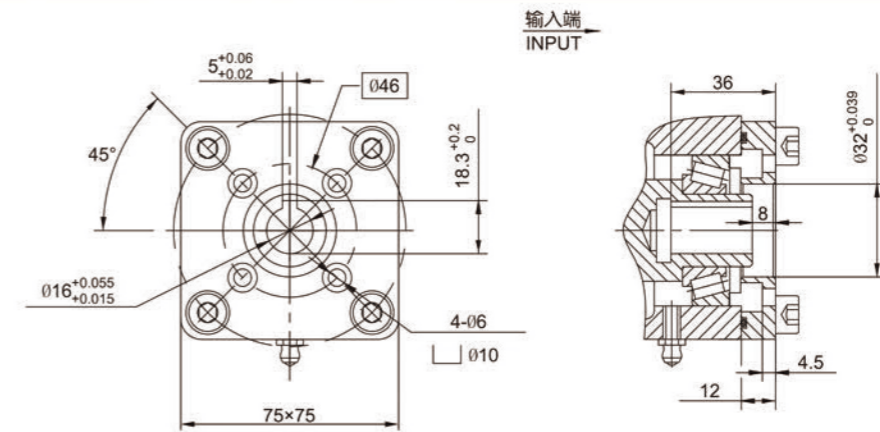

回转驱动性能参数表 Slewing Drive Performance Parameters

SE5	600 N.m	3000 N.m	5500 N.m	45 KN	22 KN	13.8 KN	11.8 KN	62 : 1	≤ 0.2°	30%	12kg
	Output Torque 输出扭矩	Tilting Moment Torque 倾覆力矩	Holding Torque 保持力矩	Static Axial Rating 轴向静载荷	Static Radial Rating 径向静载荷	Dynamic Axial Rating 轴向动载荷	Dynamic Radial Rating 径向动载荷	Gear Ratio 减速比	Accuracy 精度	Efficiency 机械效率	Weight 重量

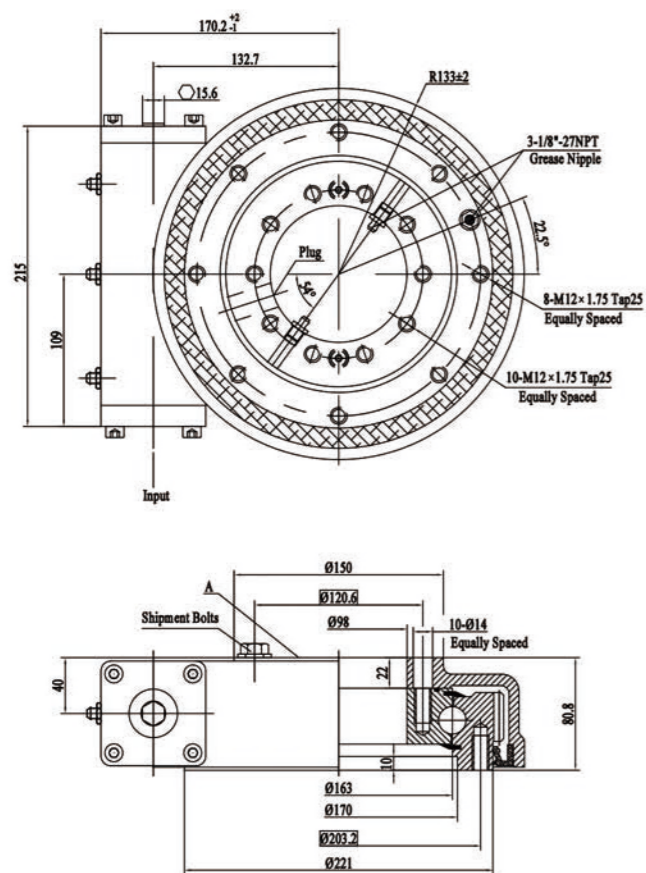

UNITS: mm
单位: mm

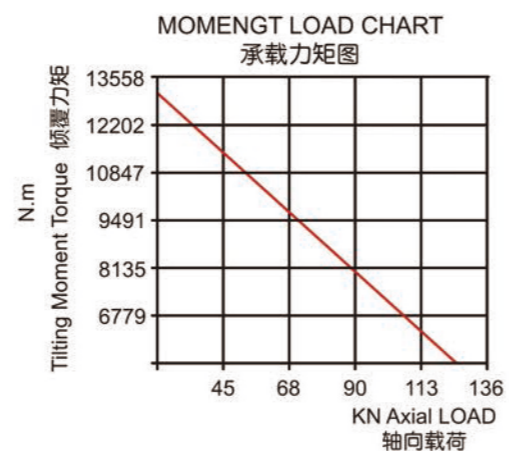

注意 Precautions: 蜗杆两端可根据客户要求进行非标准设计 “A、B” VIEW CUSTOMIZED ACCORDING TO REQUESTS

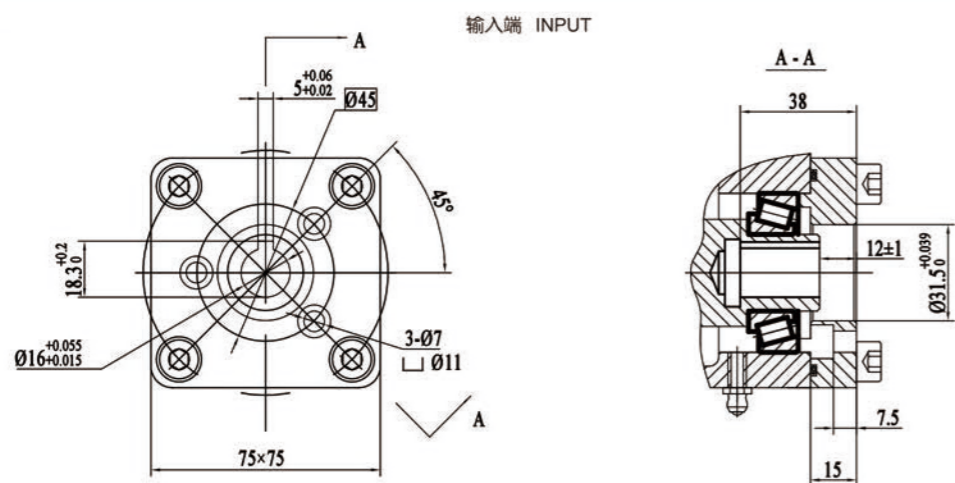

回转驱动性能参数表 Slewing Drive Performance Parameters

SE7	1500 N.m	13.5 KN.m	10.4 KN.m	133 KN	53 KN	32 KN	28 KN	73 : 1	≤ 0.15°	40%	21kg
	Output Torque	Tilting Moment Torque	Holding Torque	Static Axial Rating	Static Radial Rating	Dynamic Axial Rating	Dynamic Radial Rating	Gear Ratio	Accuracy	Efficiency	Weight
	输出扭矩	倾覆力矩	保持力矩	轴向静载荷	径向静载荷	轴向动载荷	径向动载荷	减速比	精度	机械效率	重量

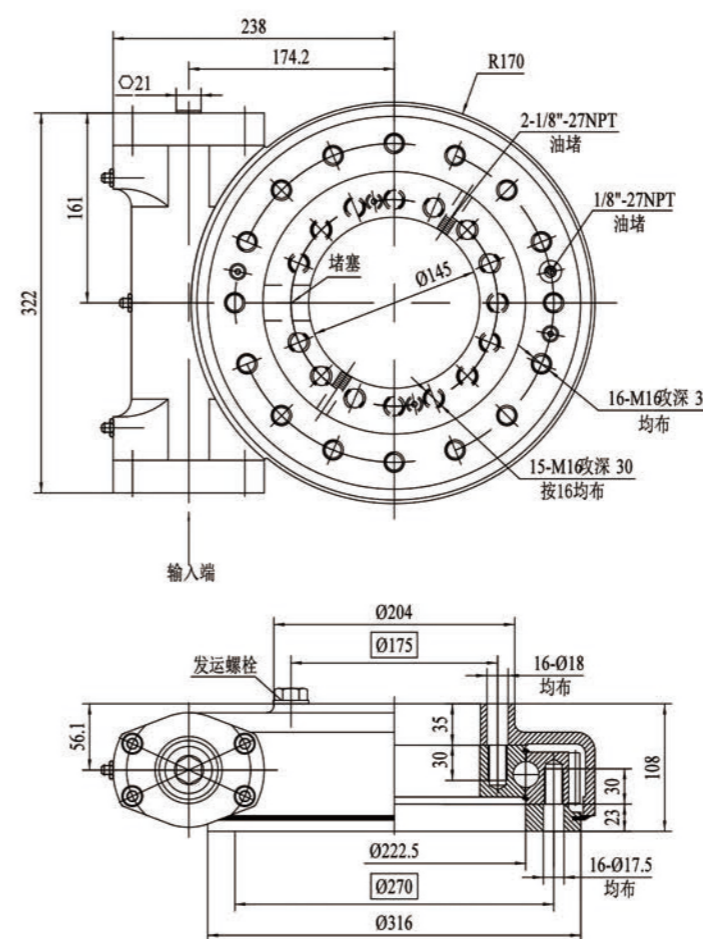

UNITS: mm
单位: mm

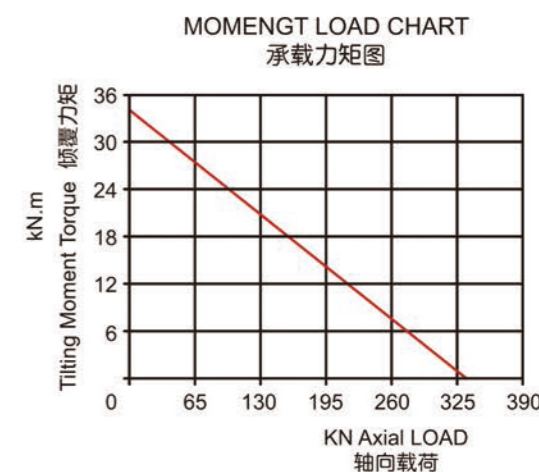

注意 Precautions: 蜗杆两端可根据客户要求进行非标准设计 “A、B” VIEW CUSTOMIZED ACCORDING TO REQUESTS

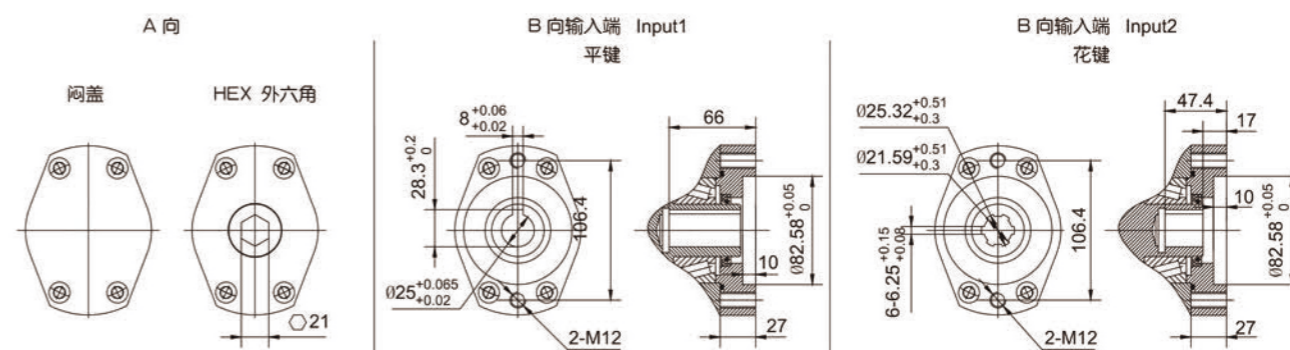

回转驱动性能参数表 Slewing Drive Performance Parameters

SE9	6.5 KN.m	33.9 KN.m	38.7 KN.m	338 KN	135 KN	81 KN	71 KN	61 : 1	≤ 0.17° C ≤ 0.09° B ≤ 0.07° A ≤ 0.05°	40%	48kg
	Output Torque	Tilting Moment Torque	Holding Torque	Static Axial Rating	Static Radial Rating	Dynamic Axial Rating	Dynamic Radial Rating	Gear Ratio	Accuracy	Efficiency	Weight
	输出扭矩	倾覆力矩	保持力矩	轴向静载荷	径向静载荷	轴向动载荷	径向动载荷	减速比	精度	机械效率	重量

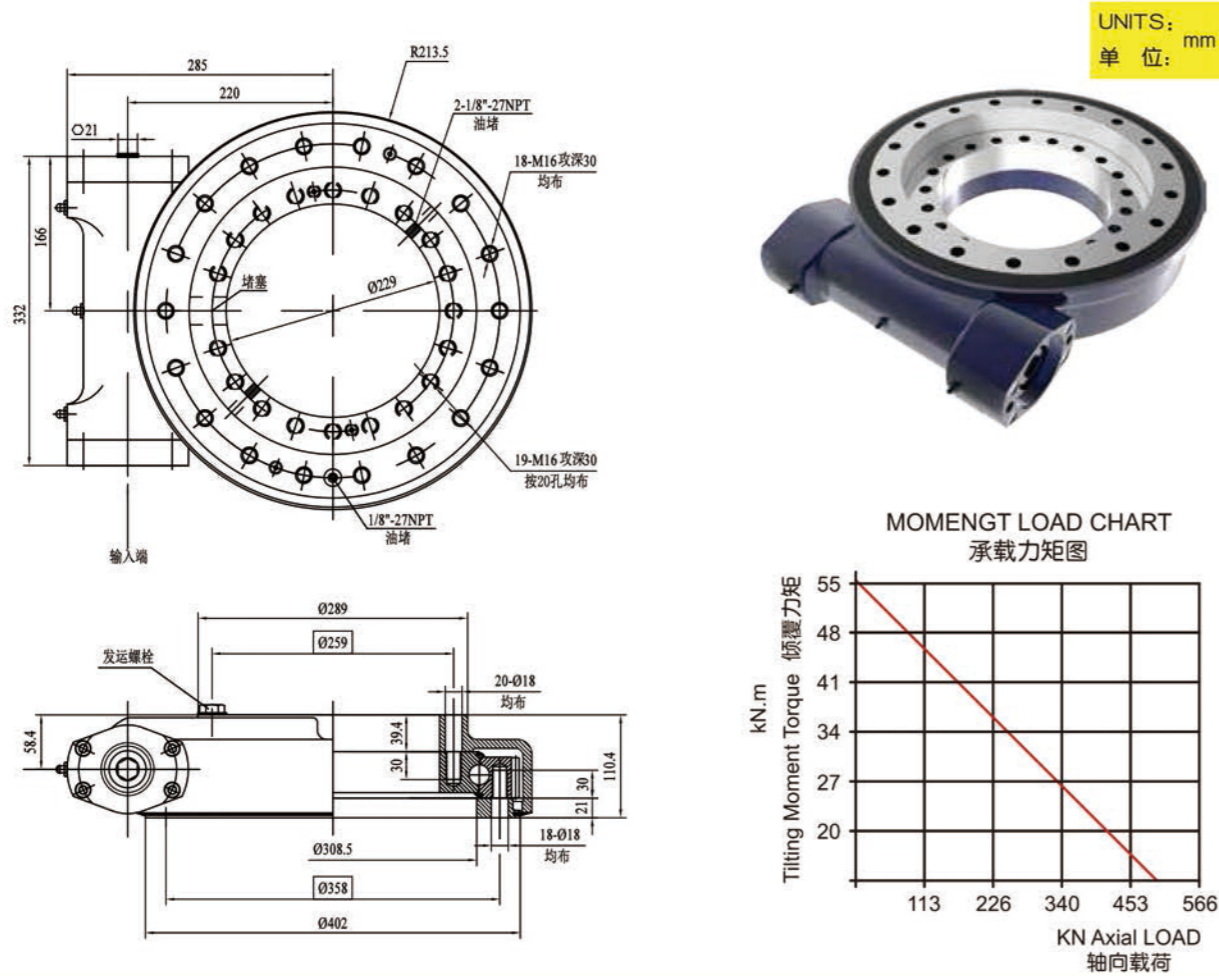

注意 Precautions: 蜗杆两端可根据客户要求非标准设计 “A、B” VIEW CUSTOMIZED ACCORDING TO REQUESTS

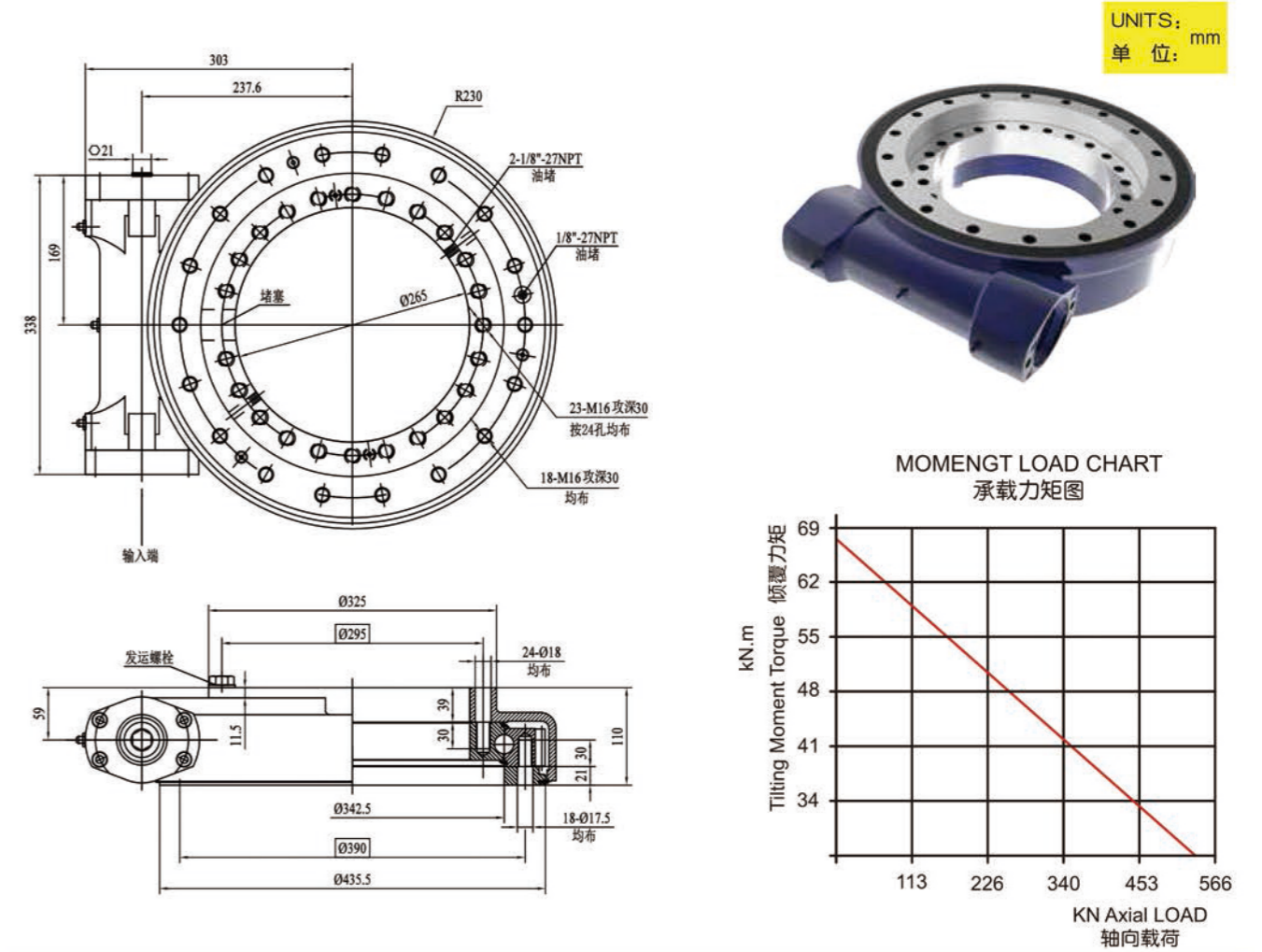

注意 Precautions: 蜗杆两端可根据客户要求非标准设计 “A、B” VIEW CUSTOMIZED ACCORDING TO REQUESTS

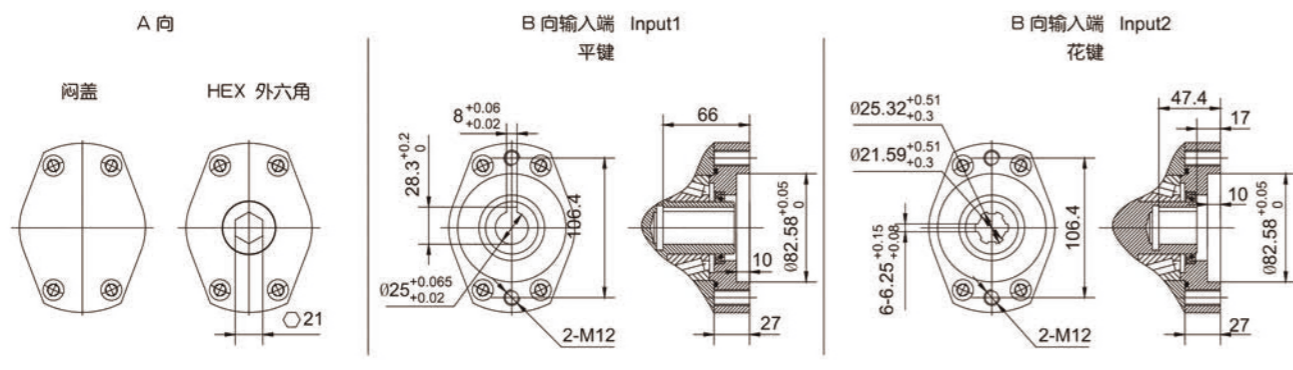

回转驱动性能参数表 Slewing Drive Performance Parameters

SE12	7.5 KN.m	54.3 KN.m	43 KN.m	475 KN	190 KN	114 KN	100 KN	78 : 1	$\Delta \le 0.17^\circ$ $C \le 0.09^\circ$ $B \le 0.07^\circ$ $A \le 0.05^\circ$	40%	61kg
	Output Torque 输出扭矩	Tilting Moment Torque 倾覆力矩	Holding Torque 保持力矩	Static Axial Rating 轴向静载荷	Static Radial Rating 径向静载荷	Dynamic Axial Rating 轴向动载荷	Dynamic Radial Rating 径向动载荷	Gear Ratio 减速比	Accuracy 精度	Efficiency 机械效率	Weight 重量

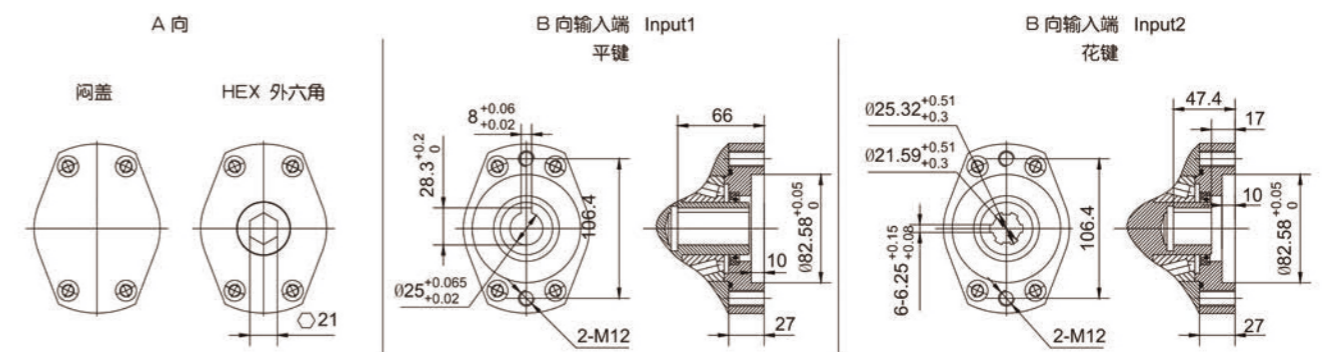

回转驱动性能参数表 Slewing Drive Performance Parameters

SE14	8 KN.m	67.8 KN.m	48 KN.m	555 KN	222 KN	133 KN	117 KN	85 : 1	$\Delta \le 0.17^\circ$ $C \le 0.09^\circ$ $B \le 0.07^\circ$ $A \le 0.05^\circ$	40%	64kg
	Output Torque 输出扭矩	Tilting Moment Torque 倾覆力矩	Holding Torque 保持力矩	Static Axial Rating 轴向静载荷	Static Radial Rating 径向静载荷	Dynamic Axial Rating 轴向动载荷	Dynamic Radial Rating 径向动载荷	Gear Ratio 减速比	Accuracy 精度	Efficiency 机械效率	Weight 重量

UNITS: mm
单位: mm

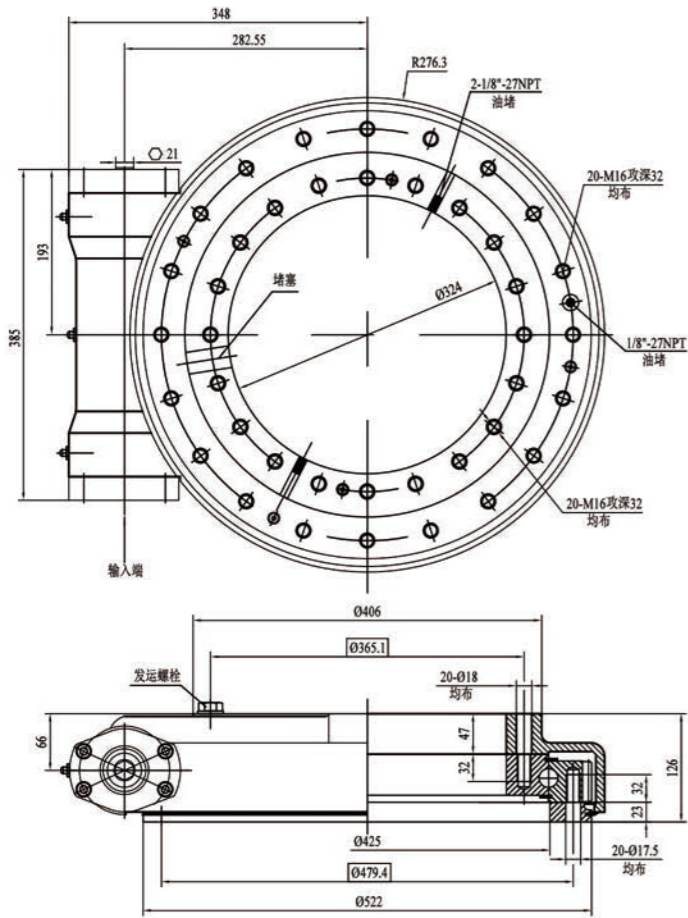

MOMENGT LOAD CHART
承载力矩图

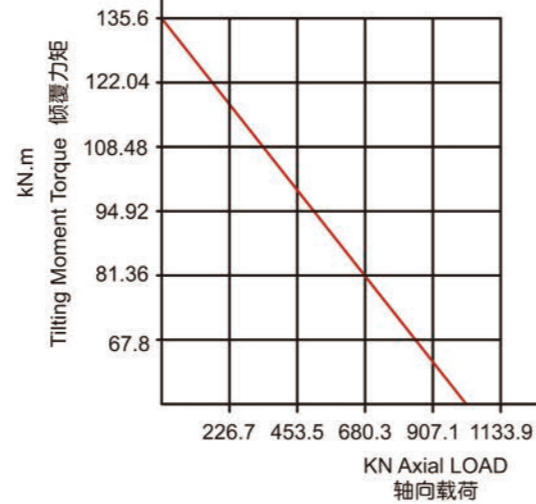

注意 Precautions: 蜗杆两端可根据客户要求进行非标准设计 "A、B" VIEW CUSTOMIZED ACCORDING TO REQUESTS

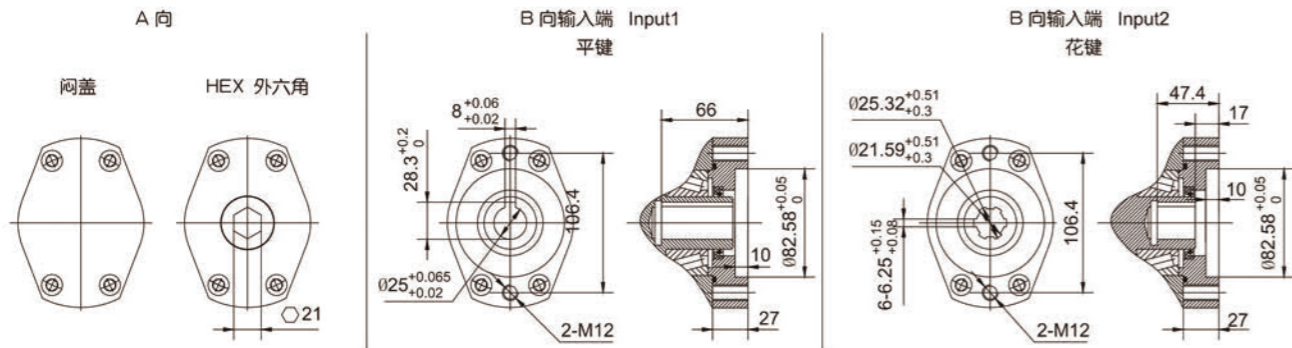

回转驱动性能参数表 Slewing Drive Performance Parameters

SE17	10 KN.m	135.6 KN.m	72.3 KN.m	970KN	390 KN	235 KN	205 KN	102 : 1	0.17° 0.09° 0.07° 0.05°	40%	105kg
	Output Torque 输出扭矩	Tilting Moment Torque 倾覆力矩	Holding Torque 保持力矩	Static Axial Rating 轴向静载荷	Static Radial Rating 径向静载荷	Dynamic Axial Rating 轴向动载荷	Dynamic Radial Rating 径向动载荷	Gear Ratio 减速比	Accuracy 精度	Efficiency 机械效率	Weight 重量

UNITS: mm
单位: mm

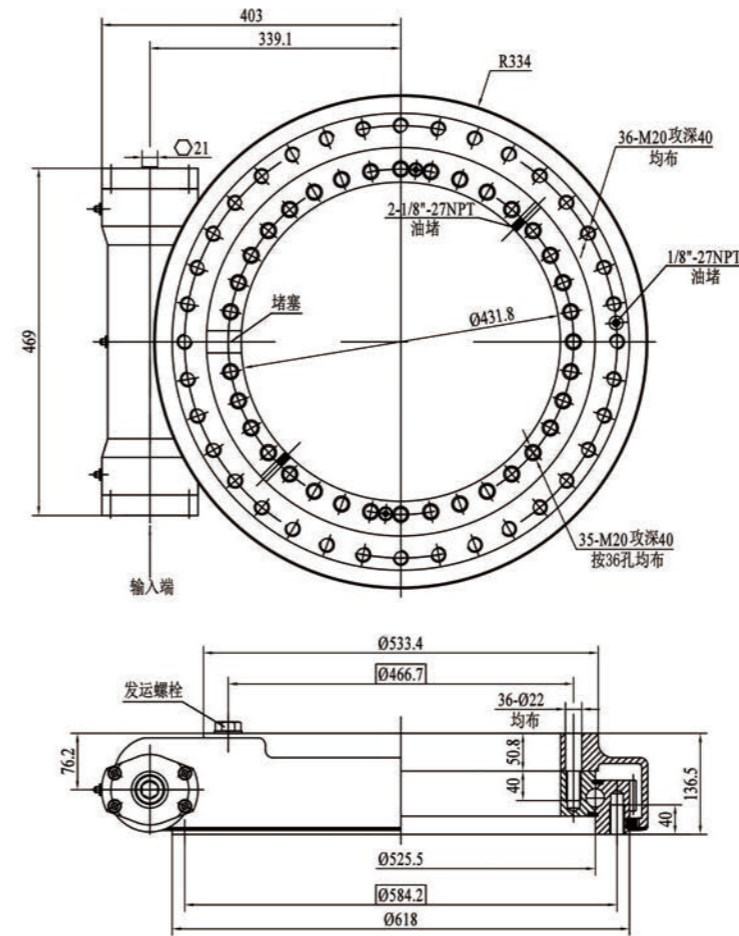

MOMENGT LOAD CHART
承载力矩图

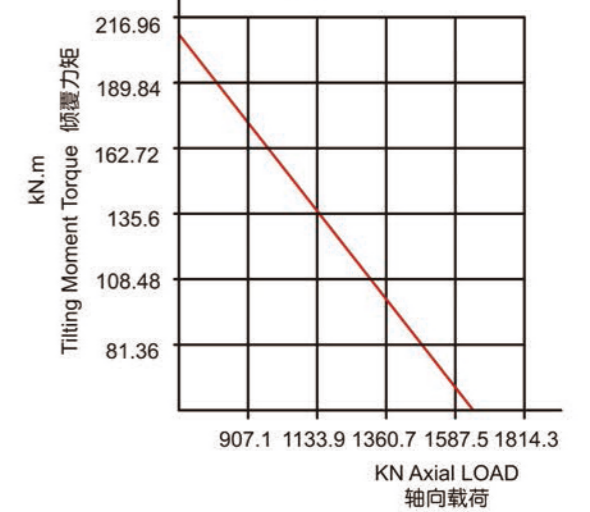

注意 Precautions: 蜗杆两端可根据客户要求进行非标准设计 "A、B" VIEW CUSTOMIZED ACCORDING TO REQUESTS

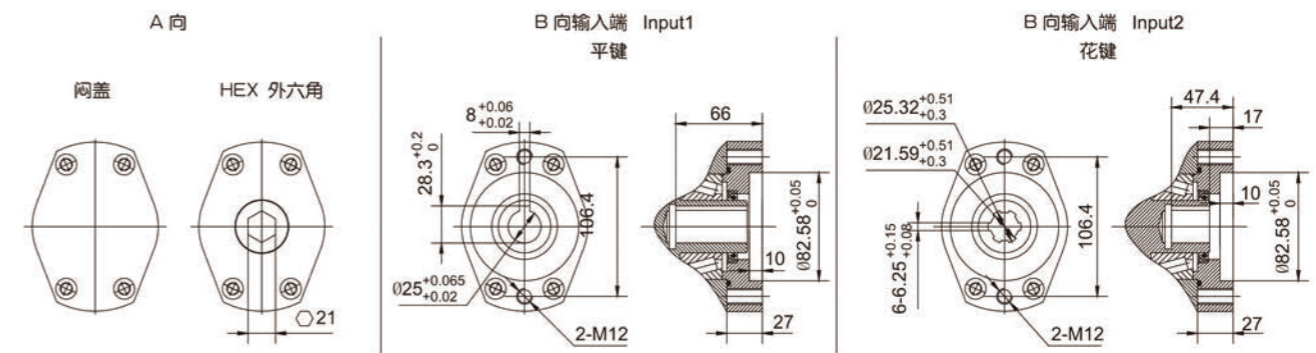

回转驱动性能参数表 Slewing Drive Performance Parameters

SE21	15 KN.m	203 KN.m	105.8 KN.m	1598 KN	640 KN	385 KN	335 KN	125 : 1	0.17° 0.09° 0.07° 0.05°	40%	149kg
	Output Torque 输出扭矩	Tilting Moment Torque 倾覆力矩	Holding Torque 保持力矩	Static Axial Rating 轴向静载荷	Static Radial Rating 径向静载荷	Dynamic Axial Rating 轴向动载荷	Dynamic Radial Rating 径向动载荷	Gear Ratio 减速比	Accuracy 精度	Efficiency 机械效率	Weight 重量

UNITS: mm
单位: mm

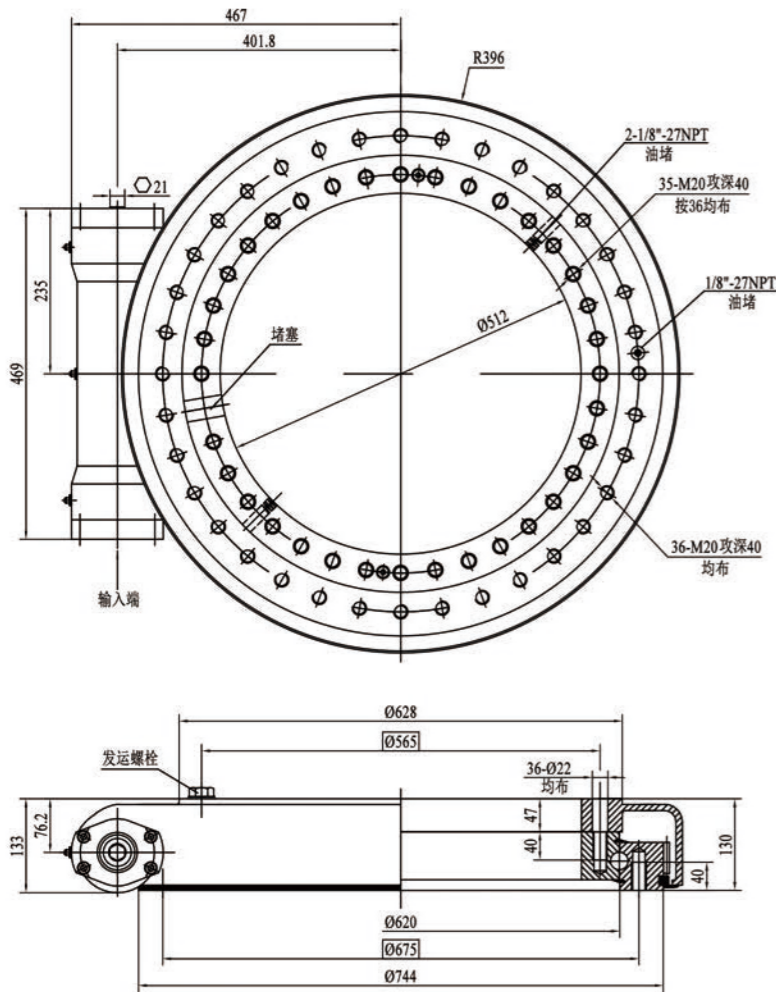

MOMENGT LOAD CHART
承载力矩图

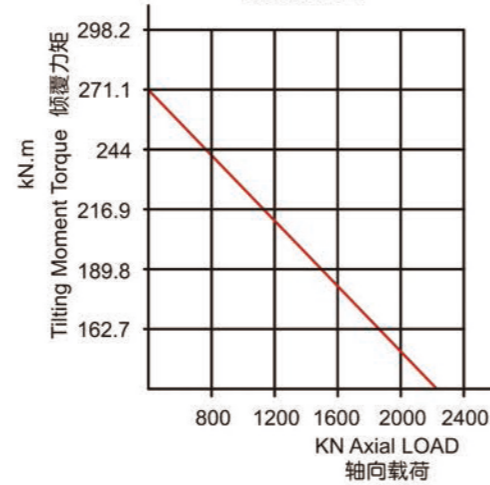

注意 Precautions: 蜗杆两端可根据客户要求进行非标准设计 "A、B" VIEW CUSTOMIZED ACCORDING TO REQUESTS

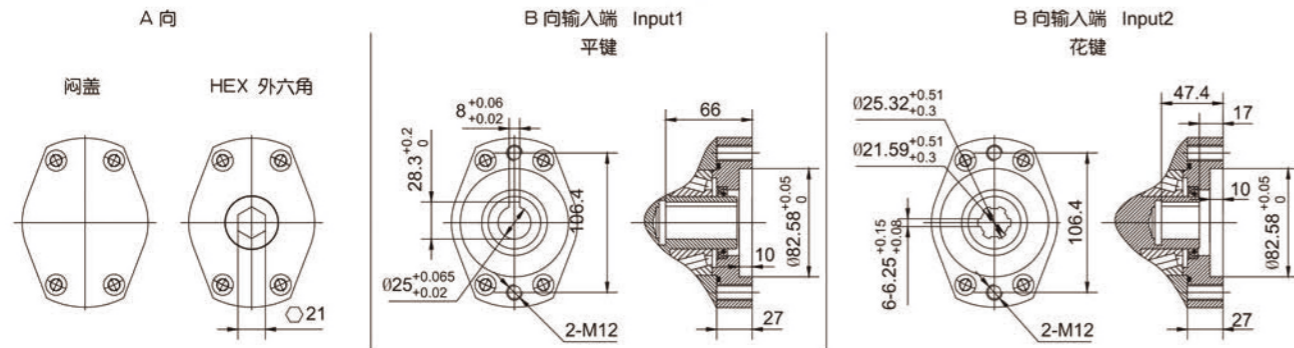

回转驱动性能参数表 Slewing Drive Performance Parameters

SE25	18 KN.m	271 KN.m	158.3 KN.m	2360 KN	945 KN	590 KN	470 KN	150 : 1	0.17° 0.09° 0.07° 0.05°	40%	204kg
	Output Torque 输出扭矩	Tilting Moment Torque 倾覆力矩	Holding Torque 保持力矩	Static Axial Rating 轴向静载荷	Static Radial Rating 径向静载荷	Dynamic Axial Rating 轴向动载荷	Dynamic Radial Rating 径向动载荷	Gear Ratio 减速比	Accuracy 精度	Efficiency 机械效率	Weight 重量

UNITS: mm
单位: mm

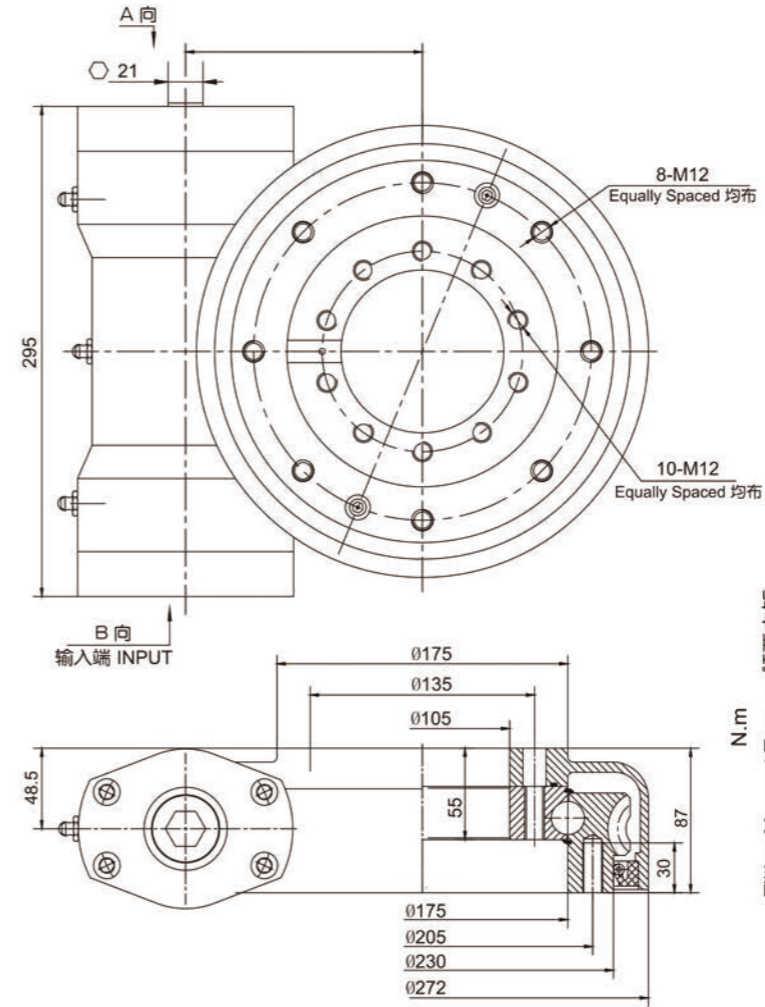

MOMENGT LOAD CHART
承载力矩图

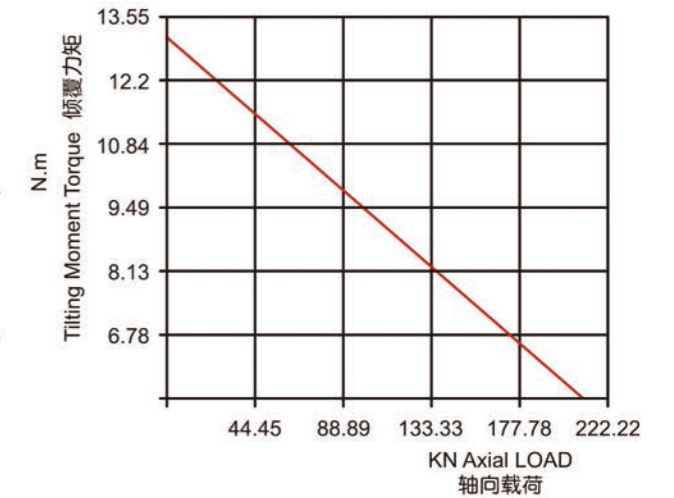

注意 Precautions: 蜗杆两端可根据客户要求进行非标准设计 "A、B" VIEW CUSTOMIZED ACCORDING TO REQUESTS

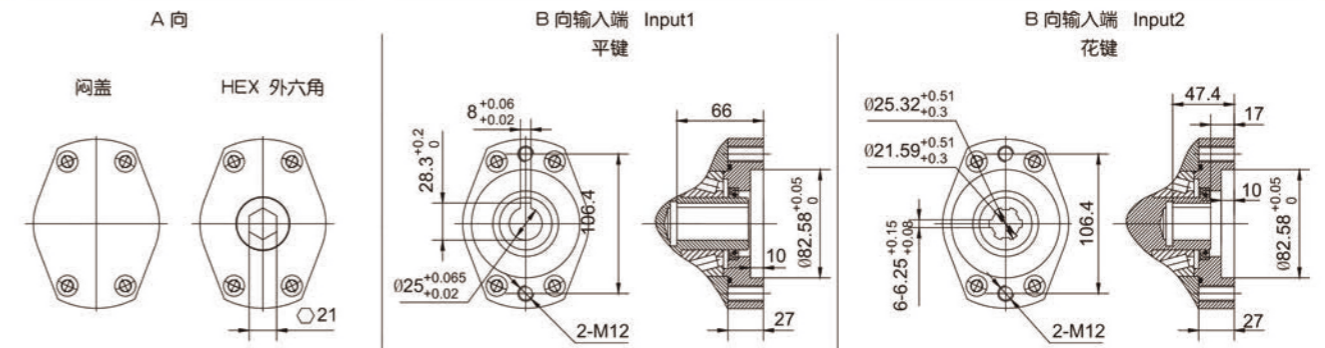

回转驱动性能参数表 Slewing Drive Performance Parameters

WEA7	3.5 KN.m	13.5 KN.m	20 KN.m	210 KN	85 KN	60 KN	45 KN	47 : 1	≤ 0.15°	40%	35kg
	Output Torque 输出扭矩	Tilting Moment Torque 倾覆力矩	Holding Torque 保持力矩	Static Axial Rating 轴向静载荷	Static Radial Rating 径向静载荷	Dynamic Axial Rating 轴向动载荷	Dynamic Radial Rating 径向动载荷	Gear Ratio 减速比	Accuracy 精度	Efficiency 机械效率	Weight 重量

UNITS: mm
单位: mm

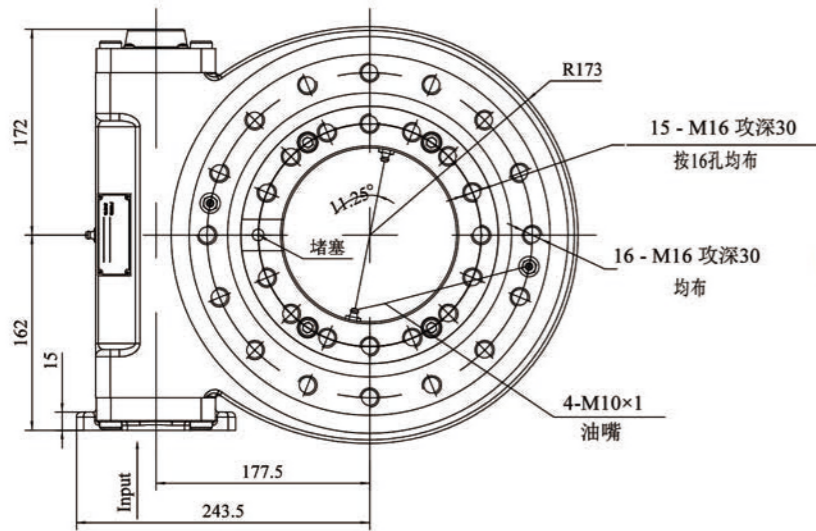

MOMENGT LOAD CHART
承载力矩图

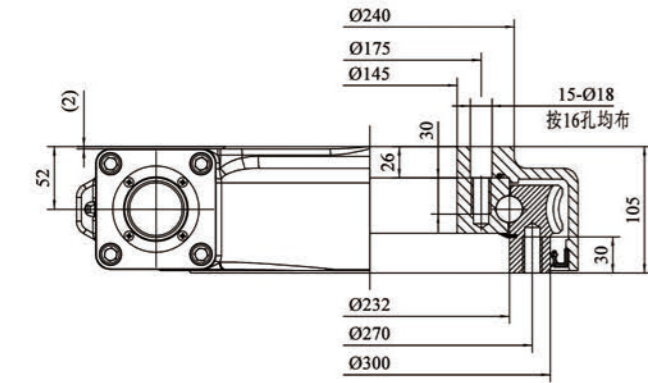
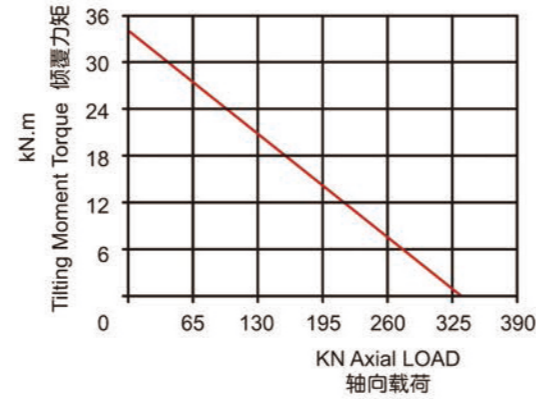

注意 Precautions: 蜗杆两端可根据客户要求非标准设计 "A、B" VIEW CUSTOMIZED ACCORDING TO REQUESTS

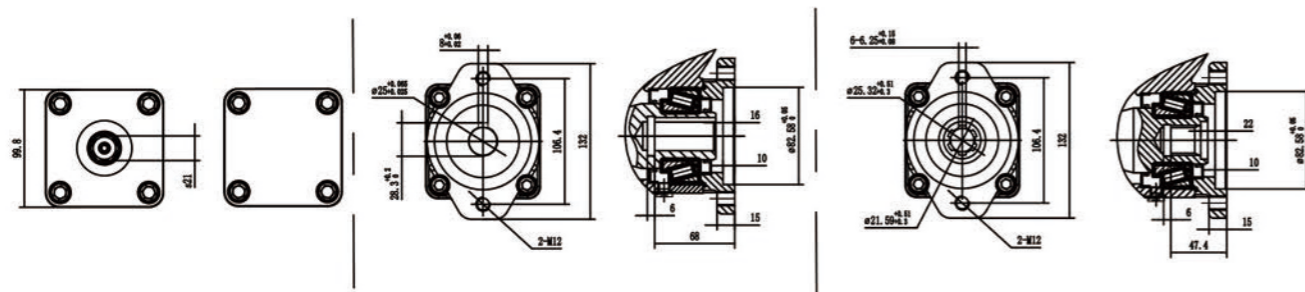

回转驱动性能参数表 Slewing Drive Performance Parameters

WEA9	8 KN.m	33.9 KN.m	38.7 KN.m	550 KN	205 KN	130 KN	110 KN	62 : 1	C < 0.17° B < 0.09° A < 0.07° A < 0.05°	40%	53kg
	Output Torque 输出扭矩	Tilting Moment Torque 倾覆力矩	Holding Torque 保持力矩	Static Axial Rating 轴向静载荷	Static Radial Rating 径向静载荷	Dynamic Axial Rating 轴向动载荷	Dynamic Radial Rating 径向动载荷	Gear Ratio 减速比	Accuracy 精度	Efficiency 机械效率	Weight 重量

UNITS: mm
单位: mm

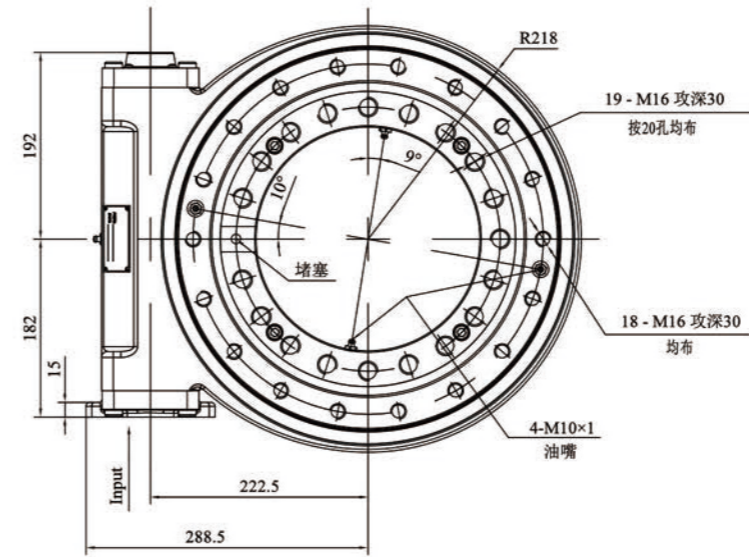

MOMENGT LOAD CHART
承载力矩图

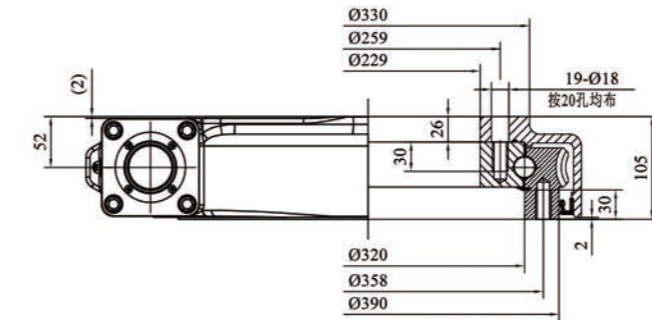
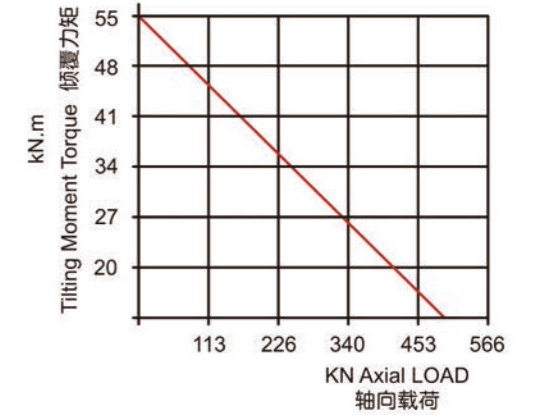

注意 Precautions: 蜗杆两端可根据客户要求非标准设计 "A、B" VIEW CUSTOMIZED ACCORDING TO REQUESTS

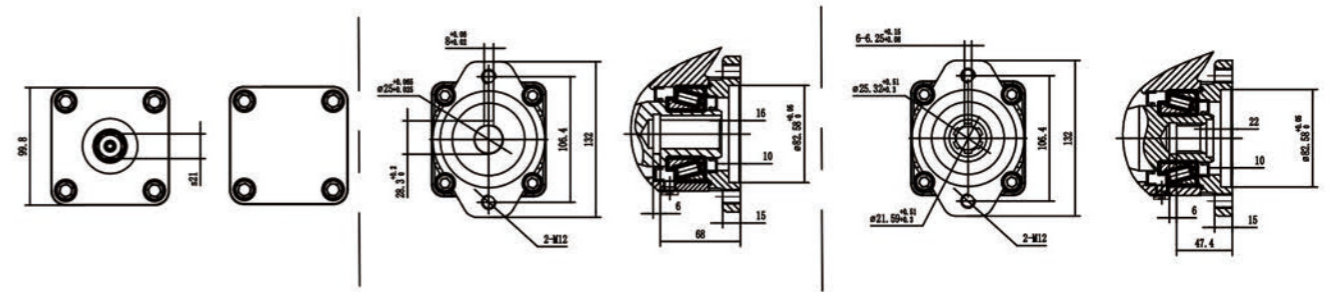

回转驱动性能参数表 Slewing Drive Performance Parameters

WEA12	9 KN.m	54.3 KN.m	43 KN.m	725 KN	270 KN	180 KN	140 KN	79 : 1	C < 0.17° B < 0.09° A < 0.07° A < 0.05°	40%	61kg
	Output Torque 输出扭矩	Tilting Moment Torque 倾覆力矩	Holding Torque 保持力矩	Static Axial Rating 轴向静载荷	Static Radial Rating 径向静载荷	Dynamic Axial Rating 轴向动载荷	Dynamic Radial Rating 径向动载荷	Gear Ratio 减速比	Accuracy 精度	Efficiency 机械效率	Weight 重量

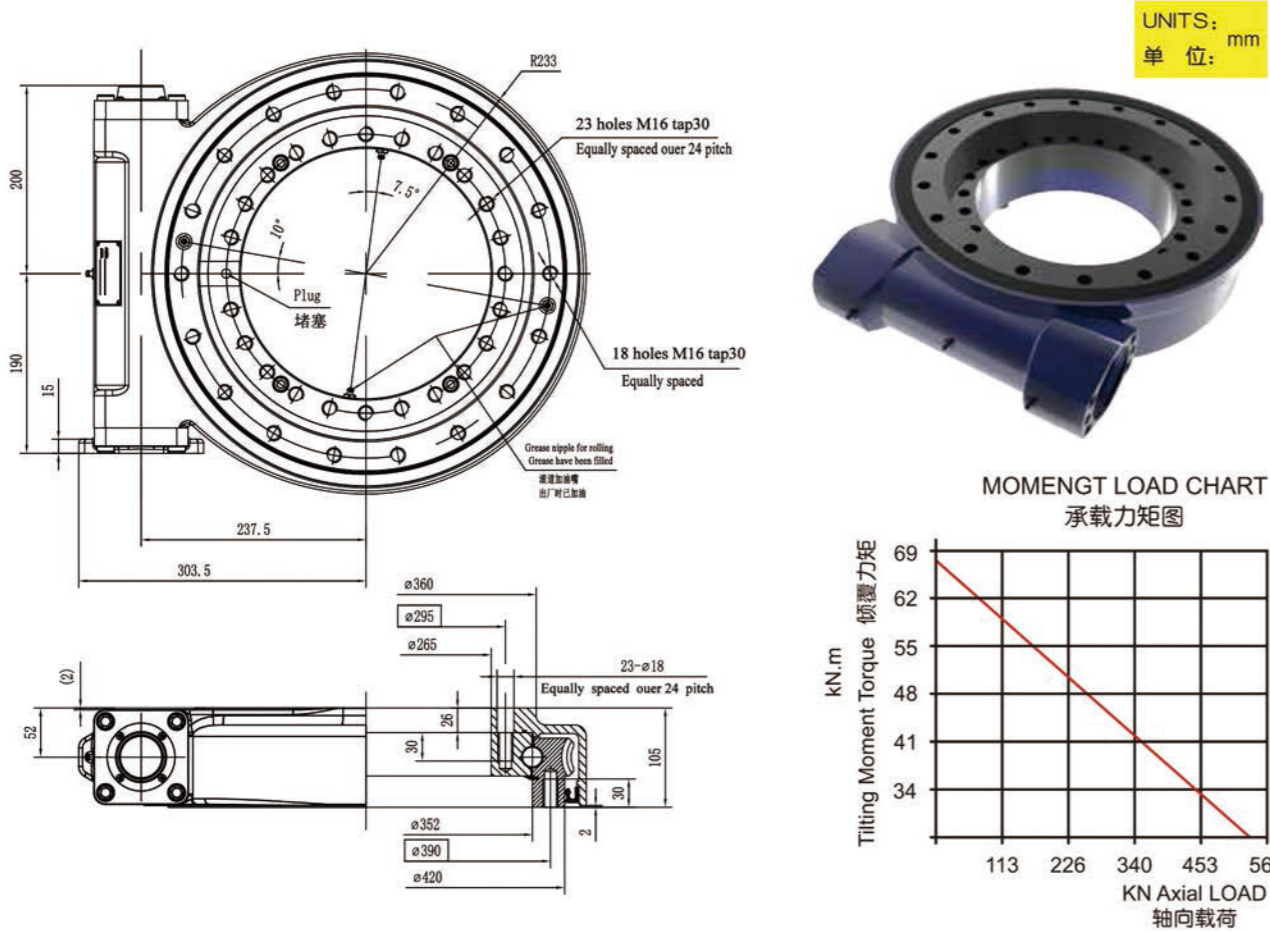

注意 Precautions: 蜗杆两端可根据客户要求进行非标准设计 "A、B" VIEW CUSTOMIZED ACCORDING TO REQUESTS

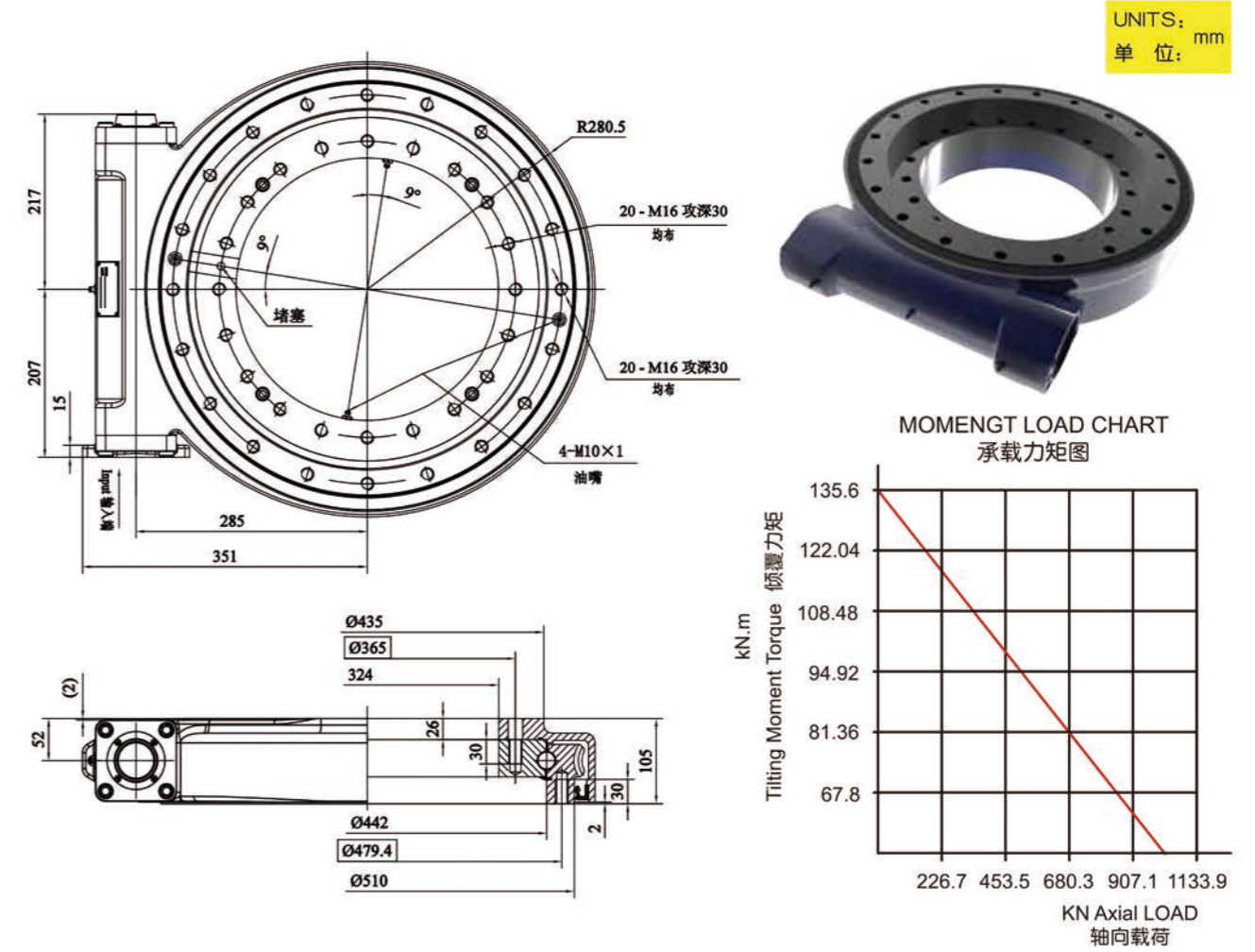

注意 Precautions: 蜗杆两端可根据客户要求进行非标准设计 "A、B" VIEW CUSTOMIZED ACCORDING TO REQUESTS

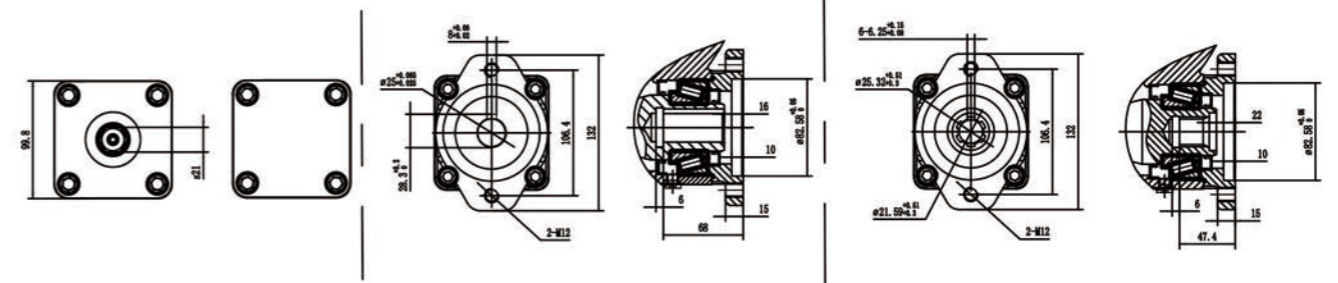
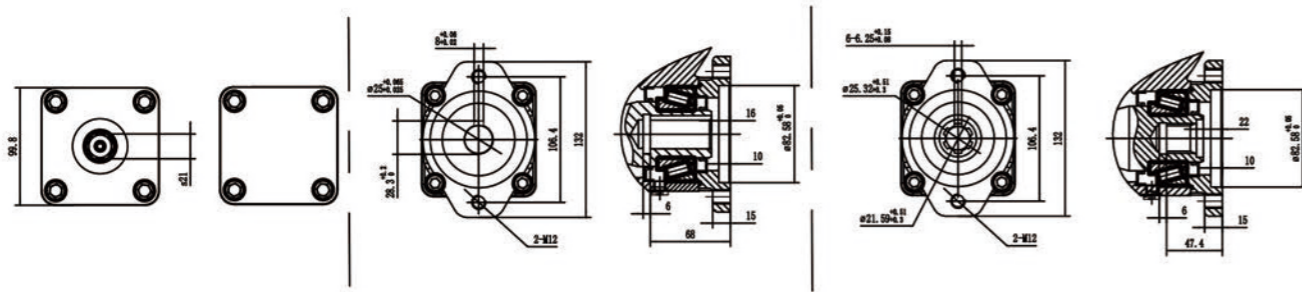

回转驱动性能参数表 Slewing Drive Performance Parameters

WEA14	10.8 KN.m	67.8 KN.m	48 KN.m	920 KN	343 KN	220 KN	190 KN	86 : 1	Δ 0.17° Δ 0.09° Δ 0.07° Δ 0.05°	40%	75kg
	Output Torque 输出扭矩	Tilting Moment Torque 倾覆力矩	Holding Torque 保持力矩	Static Axial Rating 轴向静载荷	Static Radial Rating 径向静载荷	Dynamic Axial Rating 轴向动载荷	Dynamic Radial Rating 径向动载荷	Gear Ratio 减速比	Accuracy 精度	Efficiency 机械效率	Weight 重量

回转驱动性能参数表 Slewing Drive Performance Parameters

WEA17	12.96 KN.m	135.6 KN.m	72.3 KN.m	1110KN	414 KN	266 KN	220 KN	104 : 1	Δ 0.17° Δ 0.09° Δ 0.07° Δ 0.05°	40%	96kg
	Output Torque 输出扭矩	Tilting Moment Torque 倾覆力矩	Holding Torque 保持力矩	Static Axial Rating 轴向静载荷	Static Radial Rating 径向静载荷	Dynamic Axial Rating 轴向动载荷	Dynamic Radial Rating 径向动载荷	Gear Ratio 减速比	Accuracy 精度	Efficiency 机械效率	Weight 重量

UNITS: mm
单位: mm

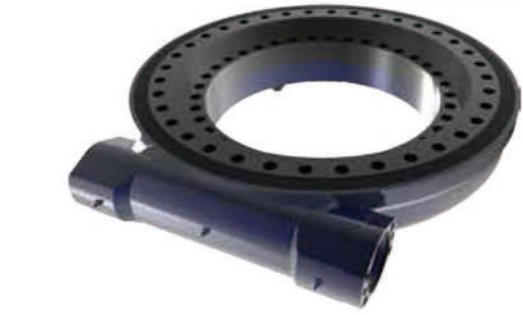
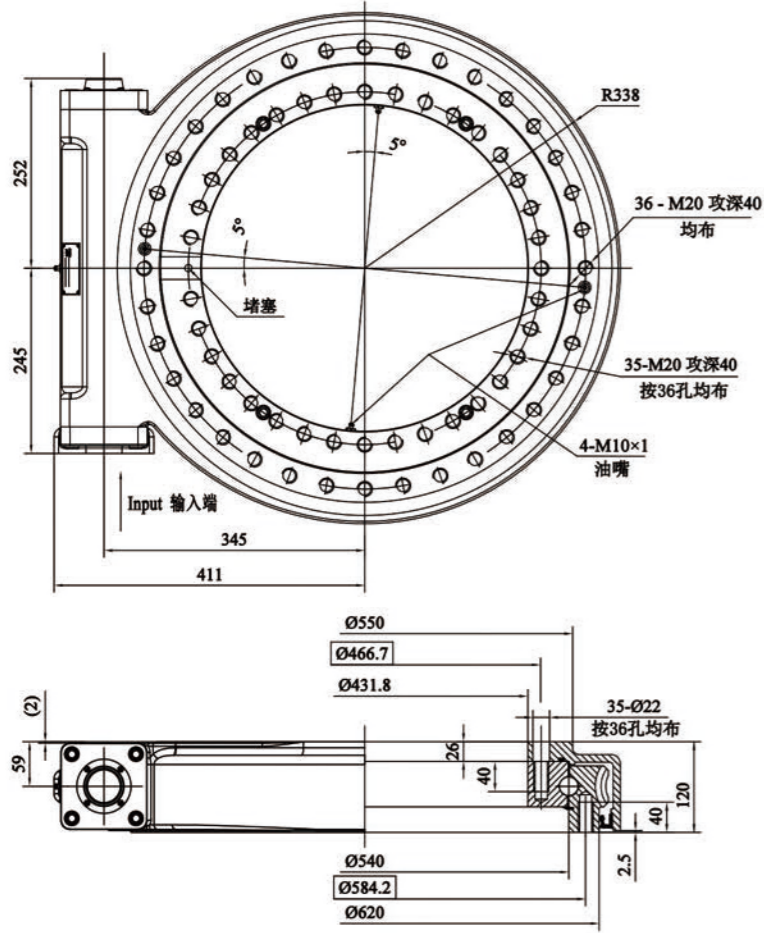

MOMENGT LOAD CHART
承载力矩图

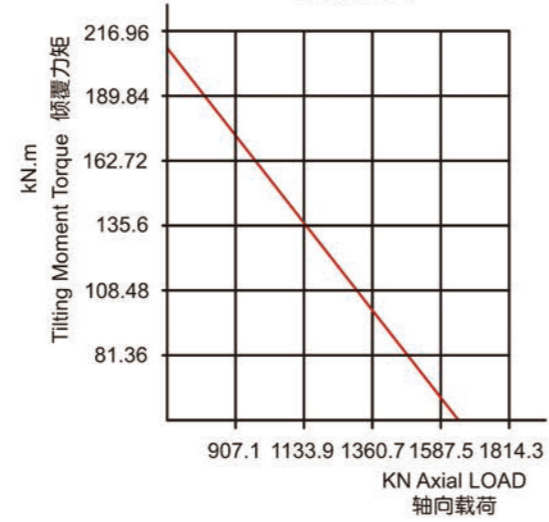

注意 Precautions: 蜗杆两端可根据客户要求进行非标准设计 "A、B" VIEW CUSTOMIZED ACCORDING TO REQUESTS

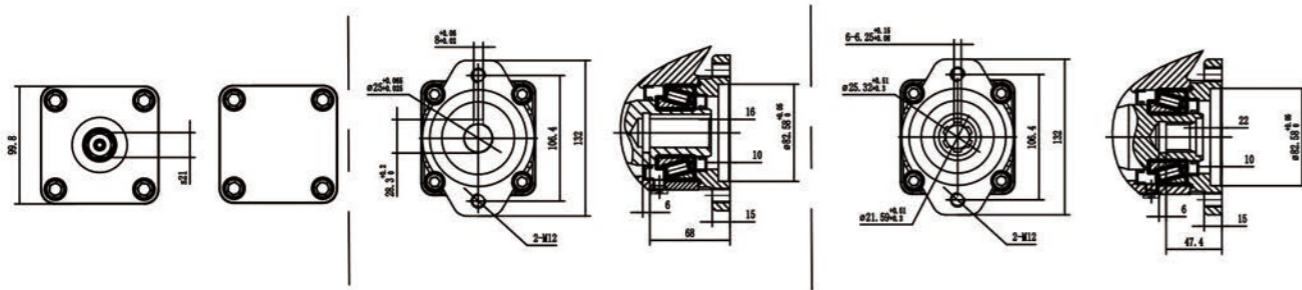

回转驱动性能参数表 Slewing Drive Performance Parameters

WEA21	28.7 KN.m	203 KN.m	105.8 KN.m	1598 KN	596 KN	340 KN	270 KN	90 : 1	C $\le 0.17^\circ$ B $\le 0.09^\circ$ A $\le 0.07^\circ$ A $\le 0.05^\circ$	40%	172kg
	Output Torque 输出扭矩	Tilting Moment Torque 倾覆力矩	Holding Torque 保持力矩	Static Axial Rating 轴向静载荷	Static Radial Rating 径向静载荷	Dynamic Axial Rating 轴向动载荷	Dynamic Radial Rating 径向动载荷	Gear Ratio 减速比	Accuracy 精度	Efficiency 机械效率	Weight 重量

UNITS: mm
单位: mm

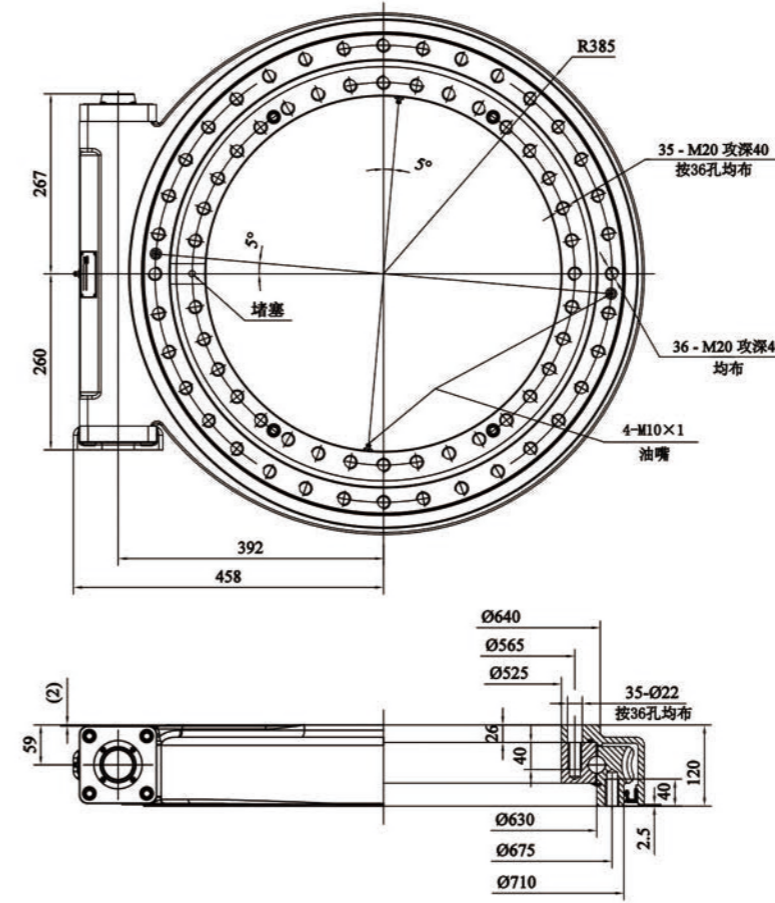

MOMENGT LOAD CHART
承载力矩图

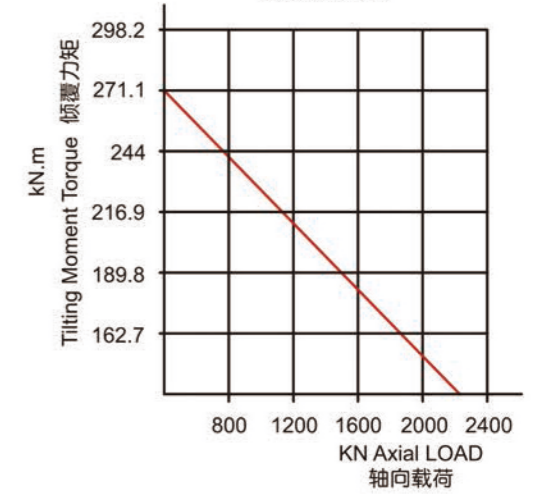

注意 Precautions: 蜗杆两端可根据客户要求进行非标准设计 "A、B" VIEW CUSTOMIZED ACCORDING TO REQUESTS

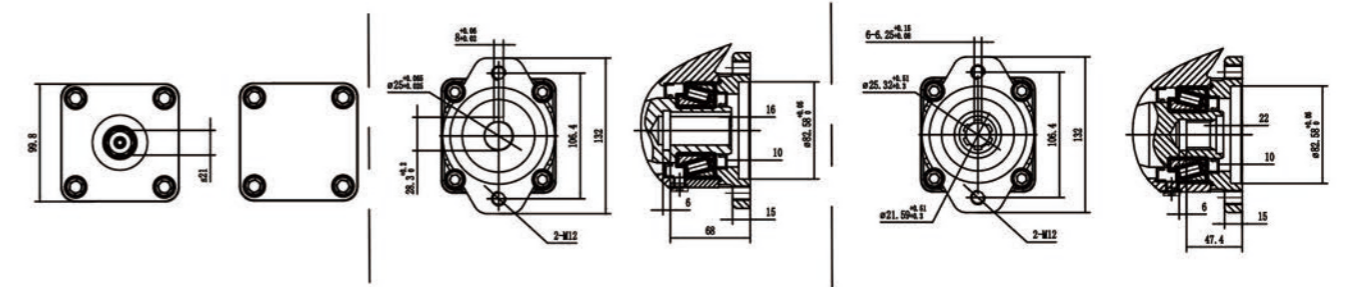

回转驱动性能参数表 Slewing Drive Performance Parameters

WEA25	34.2 KN.m	310 KN.m	158.3 KN.m	1850 KN	690 KN	440 KN	320 KN	104 : 1	C $\le 0.17^\circ$ B $\le 0.09^\circ$ A $\le 0.07^\circ$ A $\le 0.05^\circ$	40%	204kg
	Output Torque 输出扭矩	Tilting Moment Torque 倾覆力矩	Holding Torque 保持力矩	Static Axial Rating 轴向静载荷	Static Radial Rating 径向静载荷	Dynamic Axial Rating 轴向动载荷	Dynamic Radial Rating 径向动载荷	Gear Ratio 减速比	Accuracy 精度	Efficiency 机械效率	Weight 重量

UNITS: mm
单位: mm

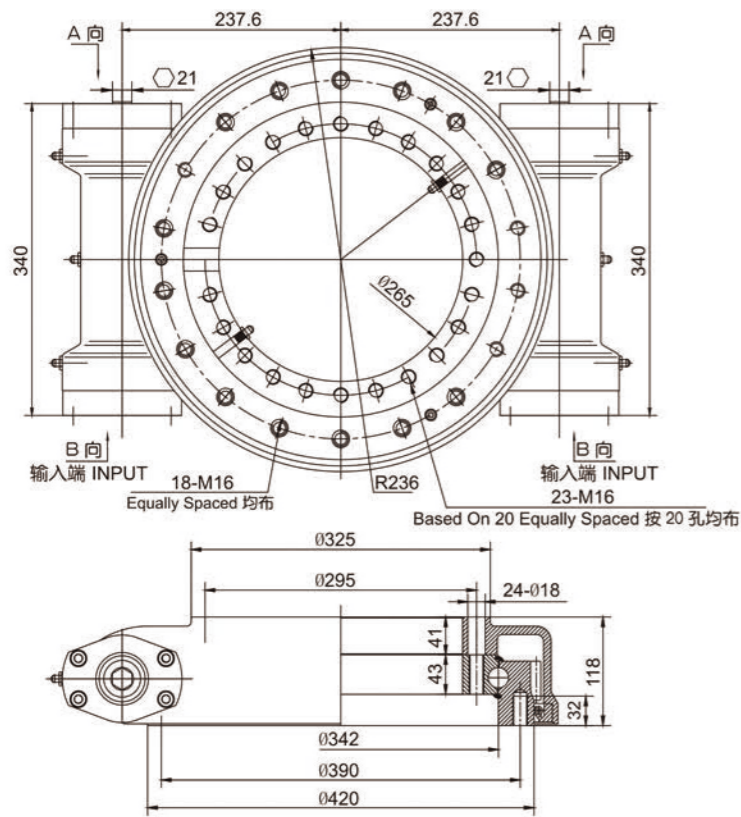

MOMENT LOAD CHART
承载力矩图

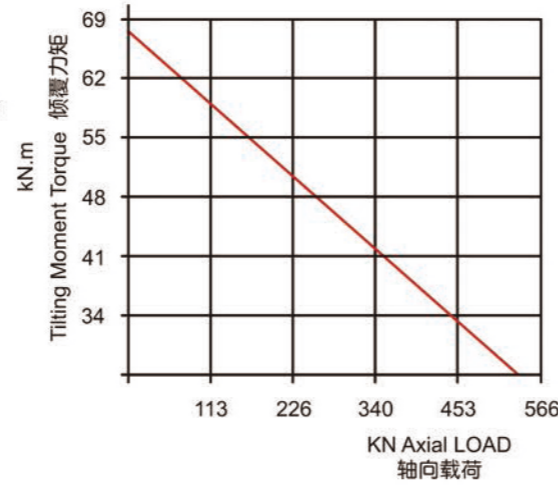

注意 Precautions: 蜗杆两端可根据客户要求非标准设计 “A、B” VIEW CUSTOMIZED ACCORDING TO REQUESTS

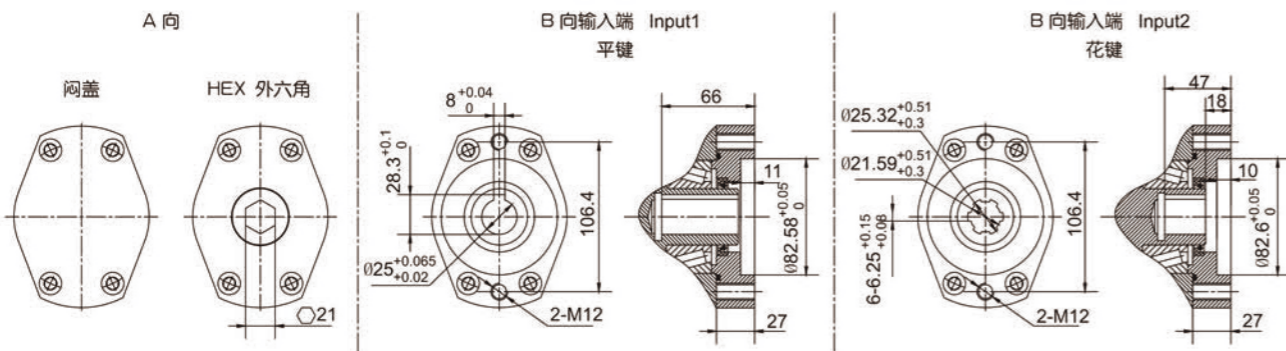

回转驱动性能参数表 Slewing Drive Performance Parameters

SE14-2	12 KN.m	67.8 KN.m	81.6 KN.m	555 KN	222 KN	133 KN	117 KN	85 : 1	CC A 0.17° B 0.09° A 0.07° A 0.05°	40%	76kg
	Output Torque 输出扭矩	Tilting Moment Torque 倾覆力矩	Holding Torque 保持力矩	Static Axial Rating 轴向静载荷	Static Radial Rating 径向静载荷	Dynamic Axial Rating 轴向动载荷	Dynamic Radial Rating 径向动载荷	Gear Ratio 减速比	Accuracy 精度	Efficiency 机械效率	Weight 重量

UNITS: mm
单位: mm

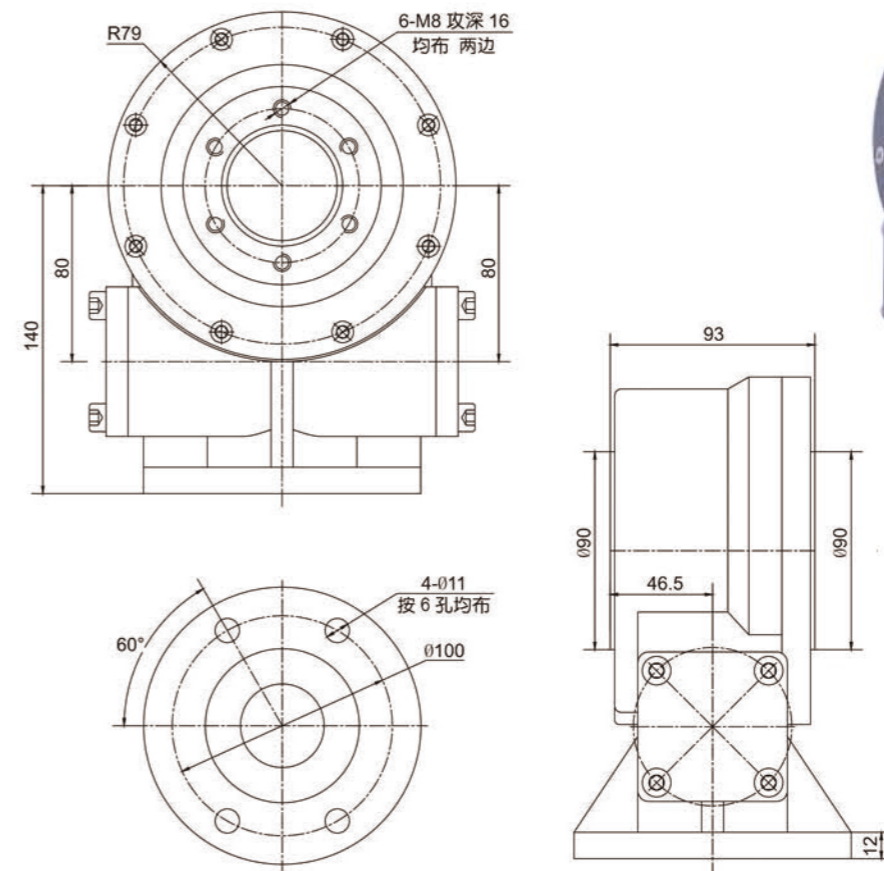

注意 Precautions: 蜗杆两端可根据客户要求非标准设计 “A、B” VIEW CUSTOMIZED ACCORDING TO REQUESTS

回转驱动性能参数表 Slewing Drive Performance Parameters

VE3	400 N.m	500 N.m	2000 N.m	30 KN	16.6 KN	9.6 KN	8.4 KN	62 : 1	≤ 0.2°	40%	12kg
	Output Torque 输出扭矩	Tilting Moment Torque 倾覆力矩	Holding Torque 保持力矩	Static Axial Rating 轴向静载荷	Static Radial Rating 径向静载荷	Dynamic Axial Rating 轴向动载荷	Dynamic Radial Rating 径向动载荷	Gear Ratio 减速比	Accuracy 精度	Efficiency 机械效率	Weight 重量

UNITS: mm
单位: mm

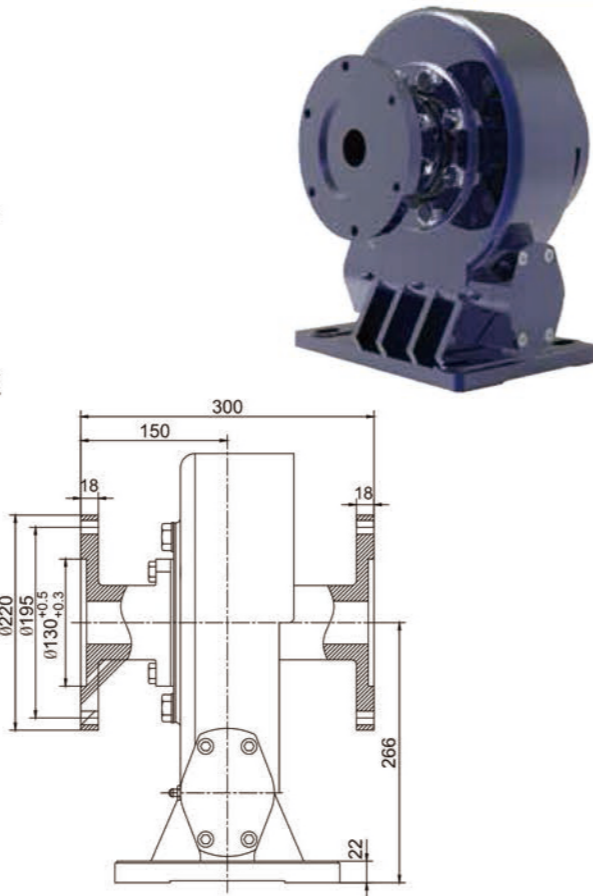
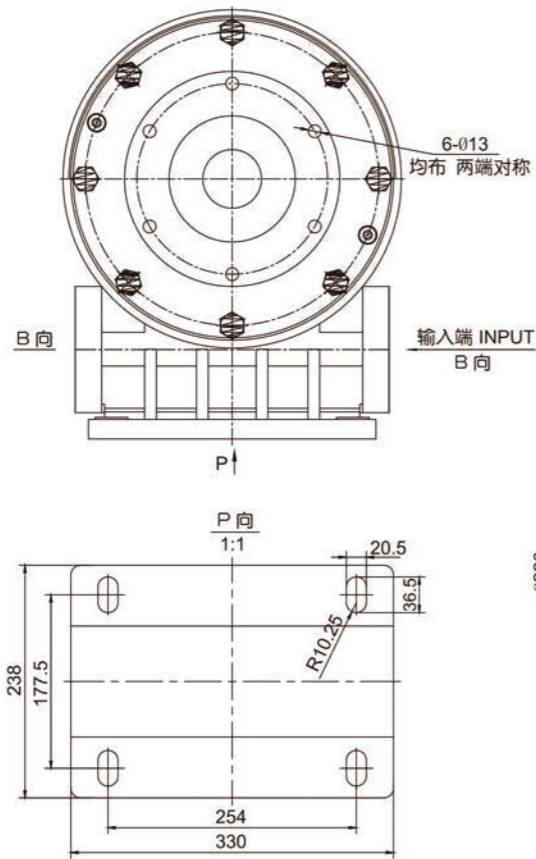

注意 Precautions: 蜗杆两端可根据客户要求非标准设计 “A、B” VIEW CUSTOMIZED ACCORDING TO REQUESTS

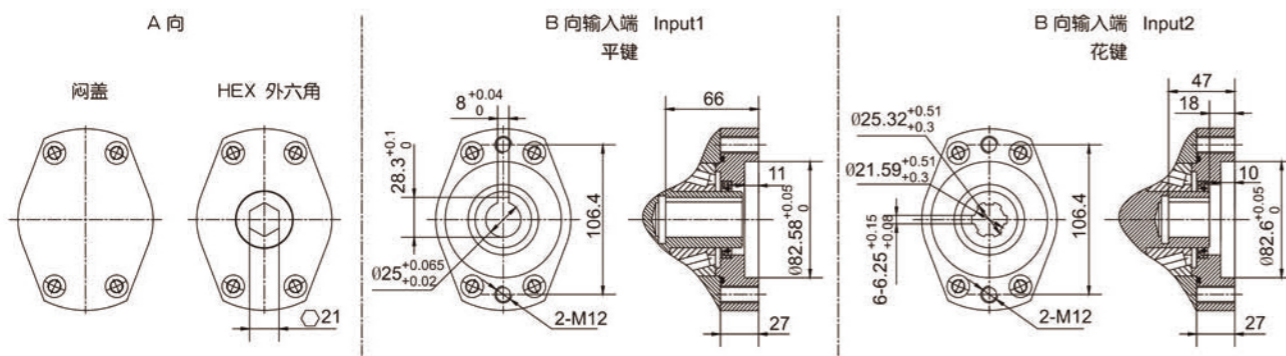

回转驱动性能参数表 Slewing Drive Performance Parameters

VE9	6.5 KN.m	12 KN.m	38.7 KN.m	338 KN	120 KN	81 KN	61 KN	61 : 1	$\begin{matrix} C < 0.17^\circ \\ B < 0.09^\circ \\ A < 0.07^\circ \\ A < 0.05^\circ \end{matrix}$	40%	60kg
	Output Torque 输出扭矩	Tilting Moment Torque 倾覆力矩	Holding Torque 保持力矩	Static Axial Rating 轴向静载荷	Static Radial Rating 径向静载荷	Dynamic Axial Rating 轴向动载荷	Dynamic Radial Rating 径向动载荷	Gear Ratio 减速比	Accuracy 精度	Efficiency 机械效率	Weight 重量

UNITS: mm
单位: mm

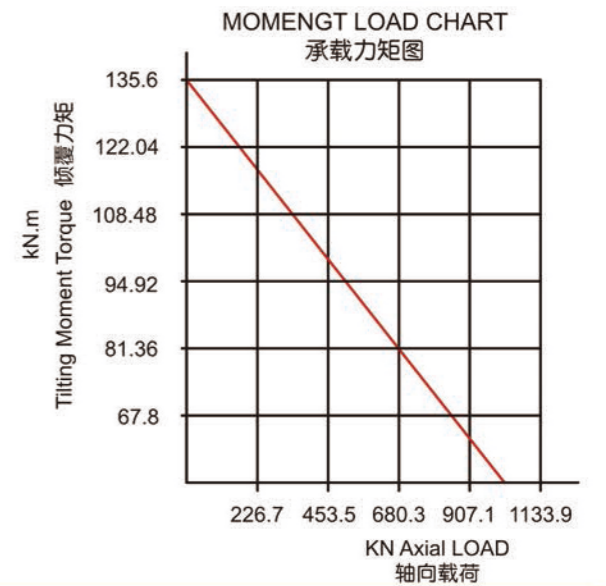
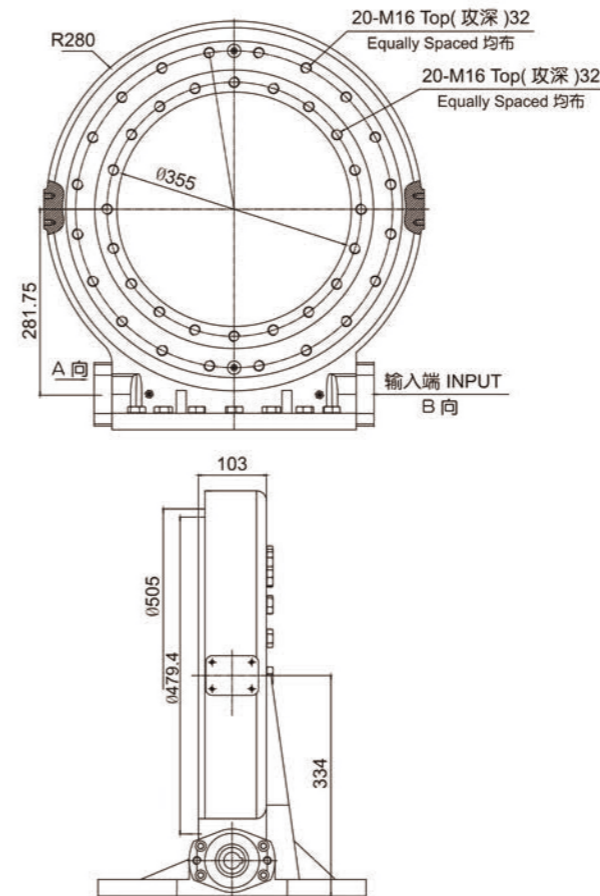

注意 Precautions: 蜗杆两端可根据客户要求非标准设计 “A、B” VIEW CUSTOMIZED ACCORDING TO REQUESTS

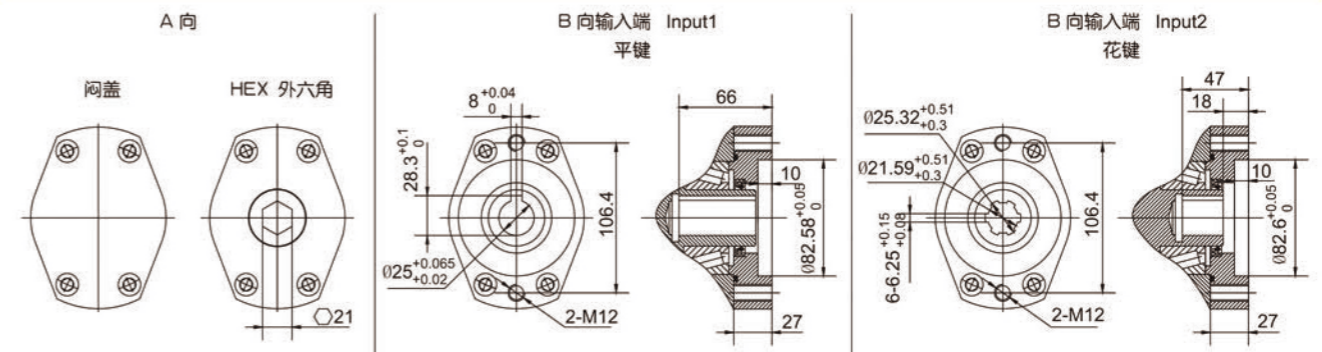

回转驱动性能参数表 Slewing Drive Performance Parameters

VE17	10 KN.m	135.6 KN.m	72.3 KN.m	970 KN	390 KN	235 KN	205 KN	102 : 1	$\begin{matrix} C < 0.17^\circ \\ B < 0.09^\circ \\ A < 0.07^\circ \\ A < 0.05^\circ \end{matrix}$	40%	105kg
	Output Torque 输出扭矩	Tilting Moment Torque 倾覆力矩	Holding Torque 保持力矩	Static Axial Rating 轴向静载荷	Static Radial Rating 径向静载荷	Dynamic Axial Rating 轴向动载荷	Dynamic Radial Rating 径向动载荷	Gear Ratio 减速比	Accuracy 精度	Efficiency 机械效率	Weight 重量

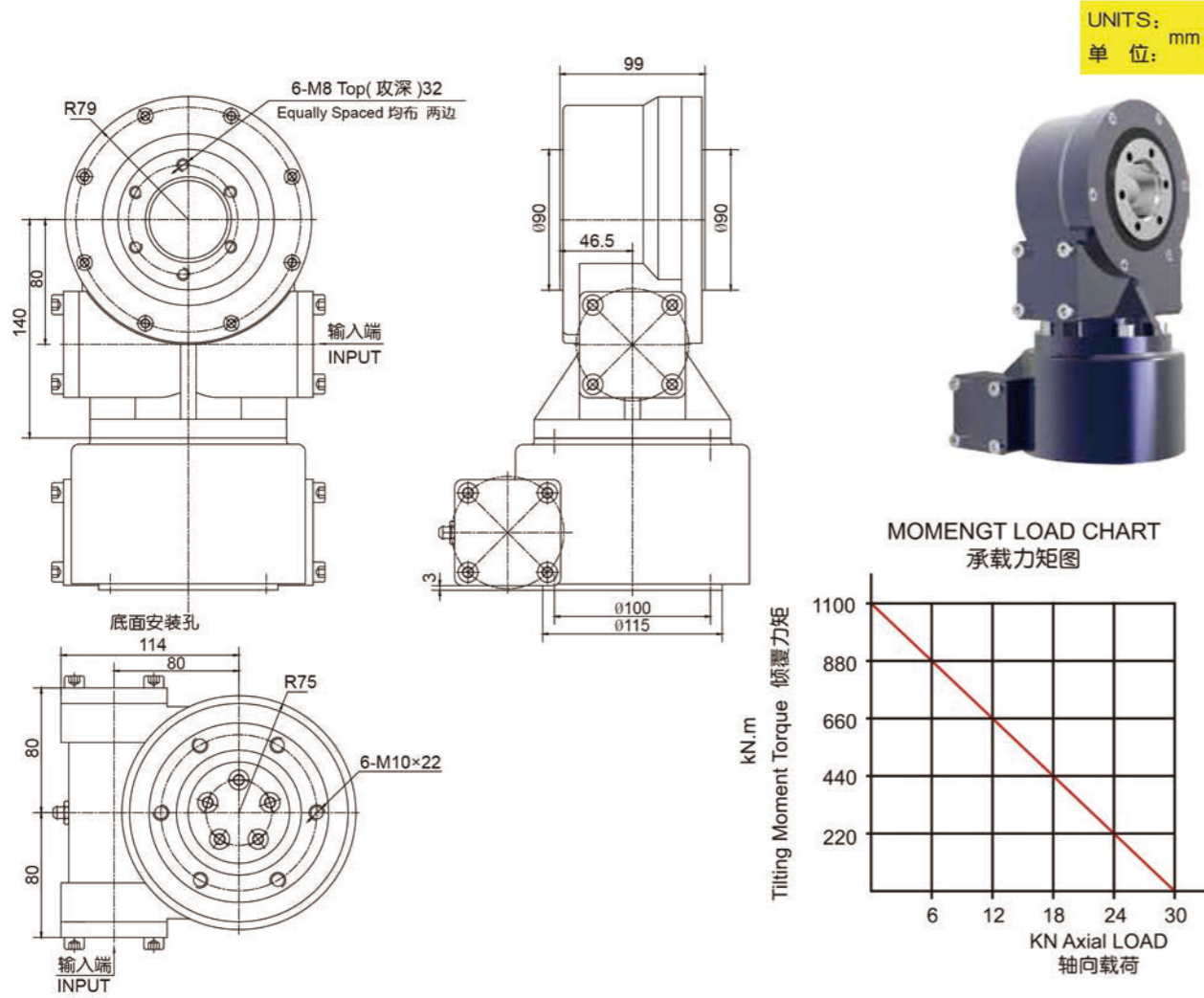

注意 Precautions: 蜗杆两端可根据客户要求非标准设计 "A、B" VIEW CUSTOMIZED ACCORDING TO REQUESTS

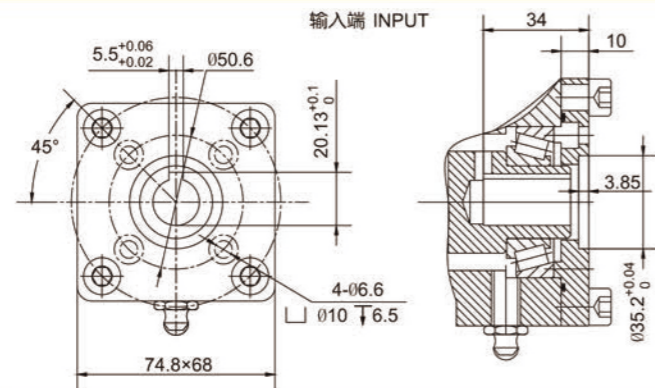

回转驱动性能参数表 Slewing Drive Performance Parameters

SDE3	400 N.m	500 N.m	2000 N.m	30 KN	15 KN	9.6 KN	8.4 KN	62 : 1	≤ 0.2°	40%	25kg
	Output Torque 输出扭矩	Tilting Moment Torque 倾覆力矩	Holding Torque 保持力矩	Static Axial Rating 轴向静载荷	Static Radial Rating 径向静载荷	Dynamic Axial Rating 轴向动载荷	Dynamic Radial Rating 径向动载荷	Gear Ratio 减速比	Accuracy 精度	Efficiency 机械效率	Weight 重量

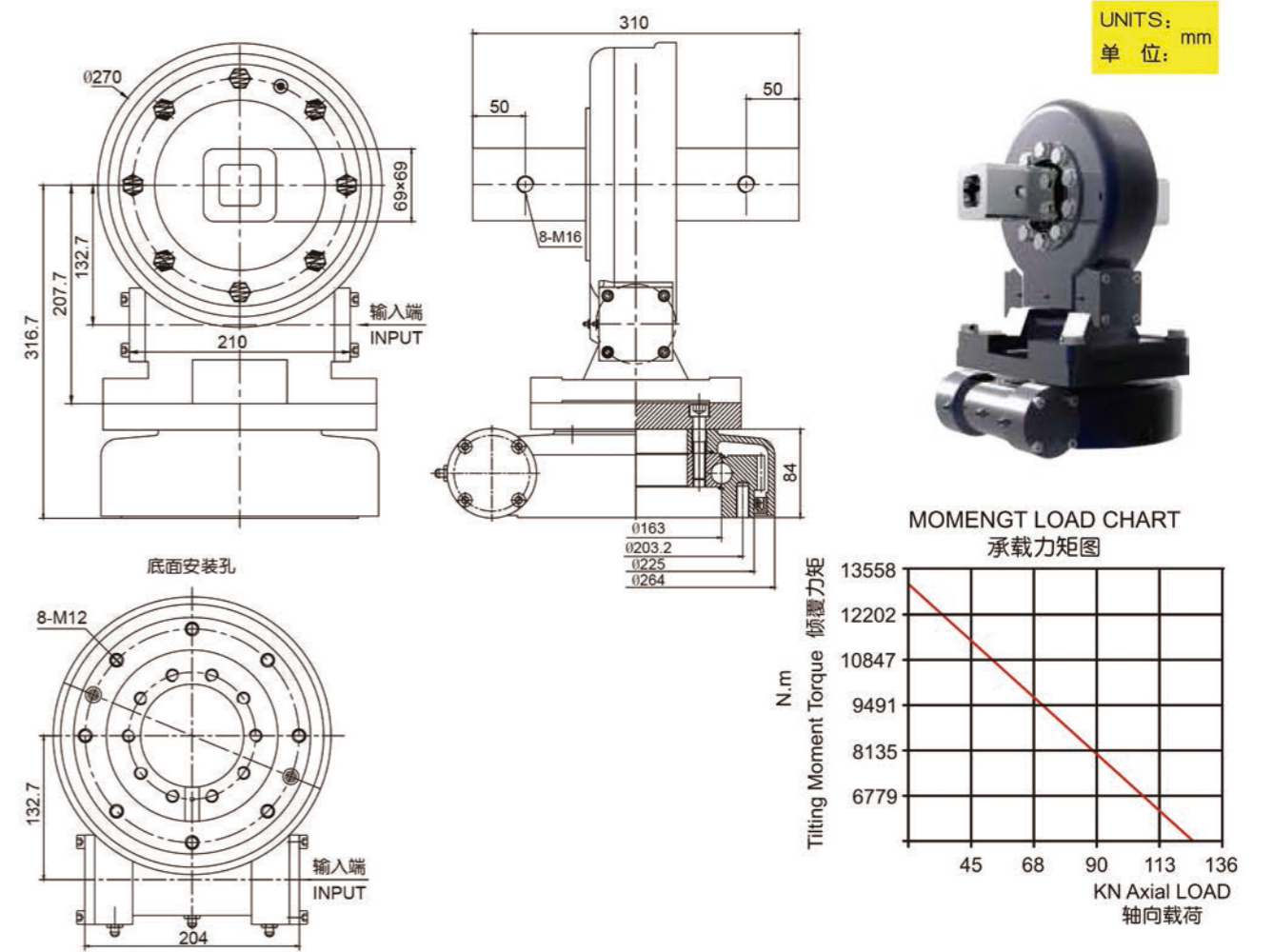

注意 Precautions: 蜗杆两端可根据客户要求非标准设计 "A、B" VIEW CUSTOMIZED ACCORDING TO REQUESTS

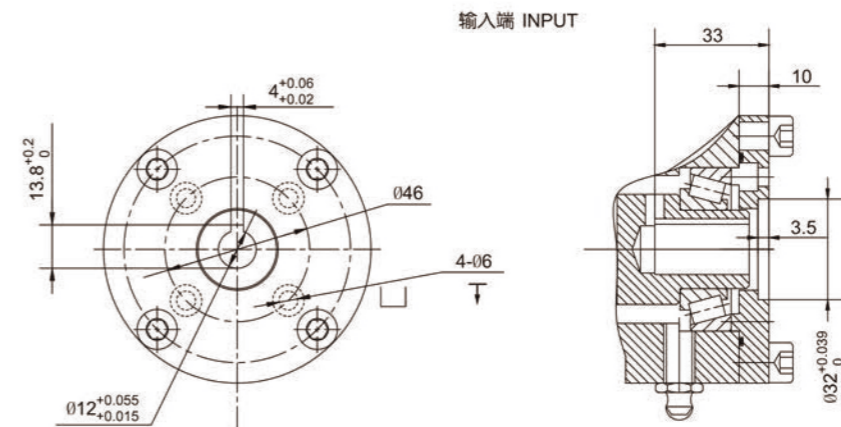

回转驱动性能参数表 Slewing Drive Performance Parameters

SDE7	1000 N.m	13.5 KN.m	10.4 KN.m	133 KN	53 KN	32 KN	28 KN	73 : 1	≤ 0.15°	40%	50kg
	Output Torque 输出扭矩	Tilting Moment Torque 倾覆力矩	Holding Torque 保持力矩	Static Axial Rating 轴向静载荷	Static Radial Rating 径向静载荷	Dynamic Axial Rating 轴向动载荷	Dynamic Radial Rating 径向动载荷	Gear Ratio 减速比	Accuracy 精度	Efficiency 机械效率	Weight 重量

UNITS: mm
单位: mm

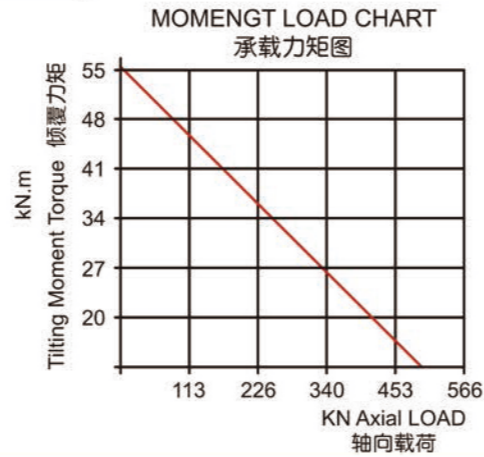
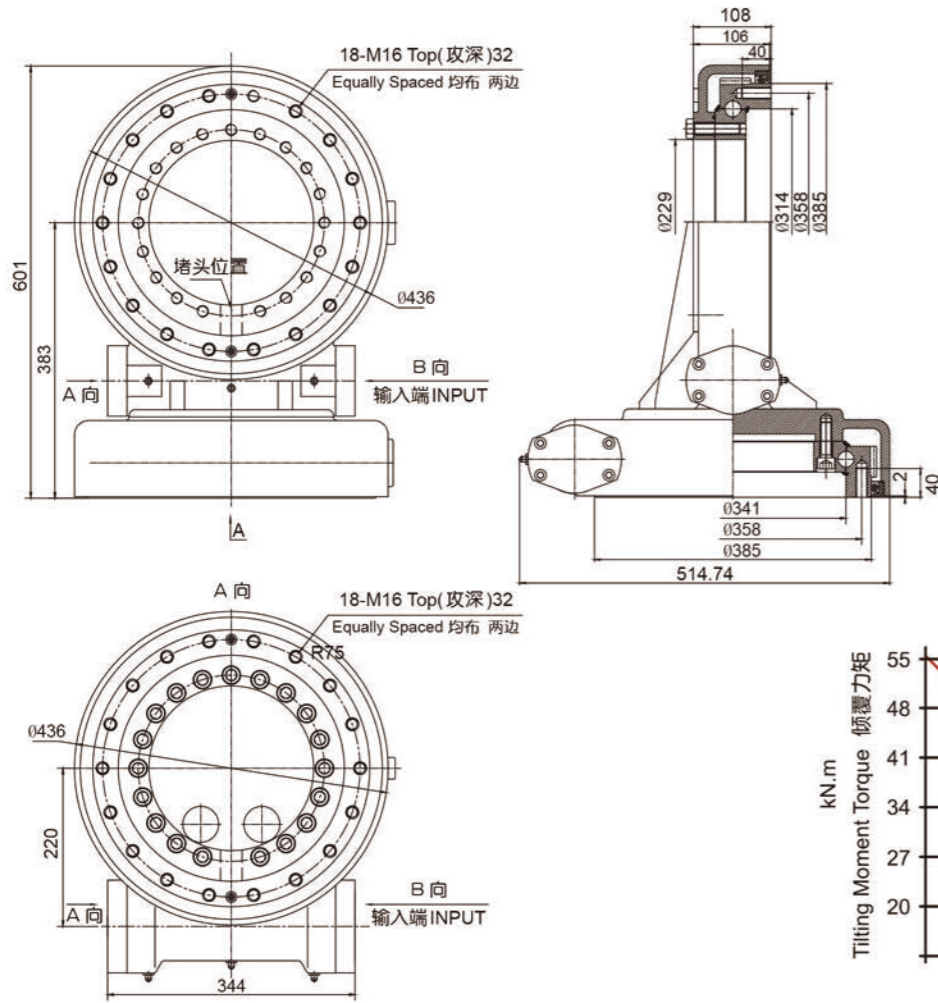

注意 Precautions: 蜗杆两端可根据客户要求非标准设计 “A、B” VIEW CUSTOMIZED ACCORDING TO REQUESTS

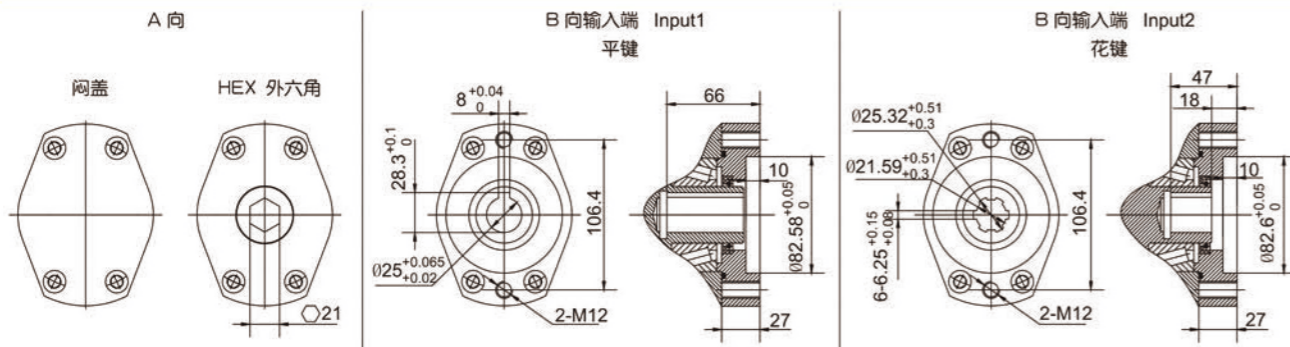

回转驱动性能参数表 Slewing Drive Performance Parameters

SDE12	7.5 KN.m	54.3 KN.m	43 KN.m	475 KN	190 KN	114 KN	100 KN	78 : 1	0.17° 0.09° 0.07° 0.05°	40%	150kg
	Output Torque 输出扭矩	Tilting Moment Torque 倾覆力矩	Holding Torque 保持力矩	Static Axial Rating 轴向静载荷	Static Radial Rating 径向静载荷	Dynamic Axial Rating 轴向动载荷	Dynamic Radial Rating 径向动载荷	Gear Ratio 减速比	Accuracy 精度	Efficiency 机械效率	Weight 重量

UNITS: mm
单位: mm

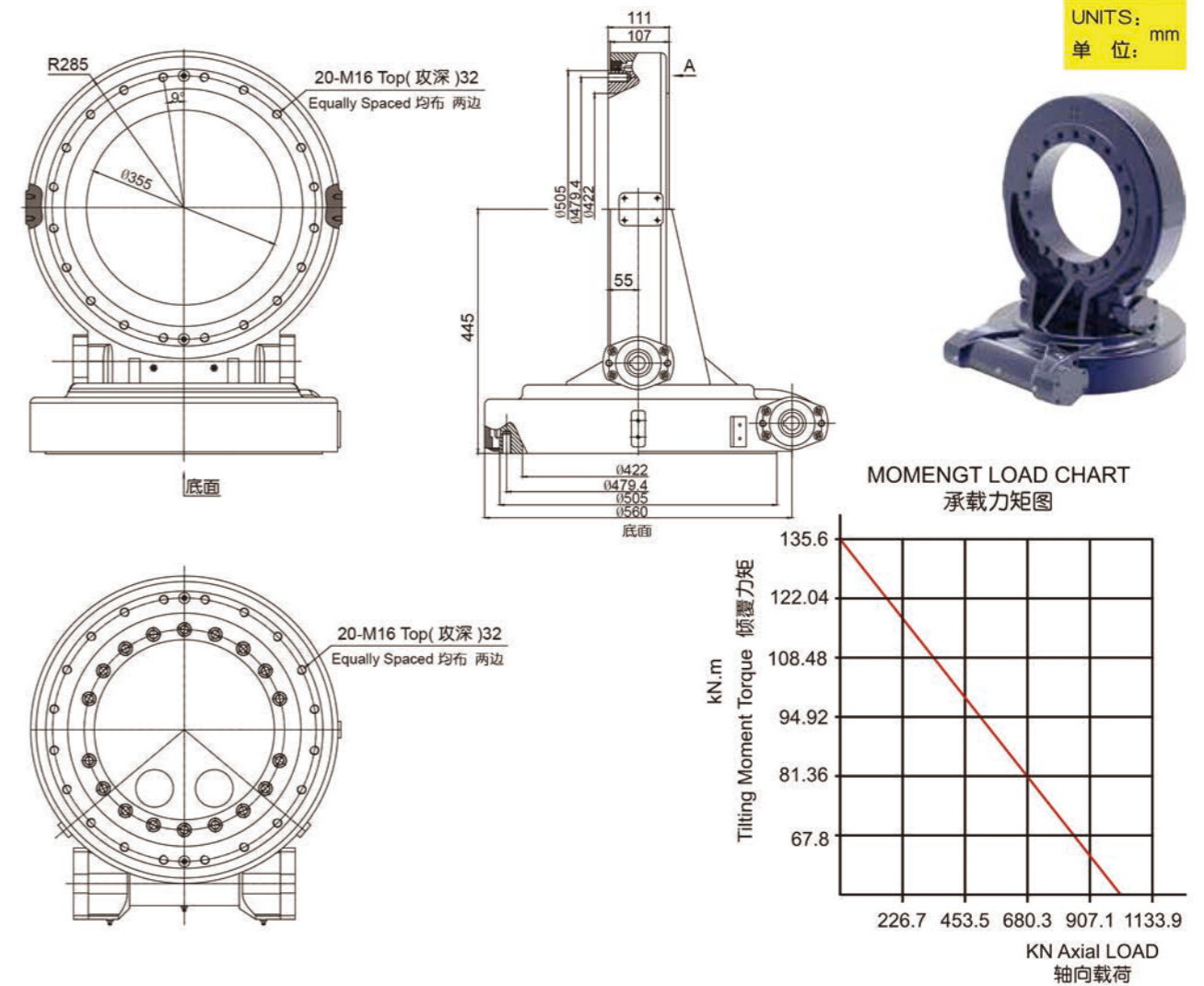

MOMENT LOAD CHART 承载力矩图

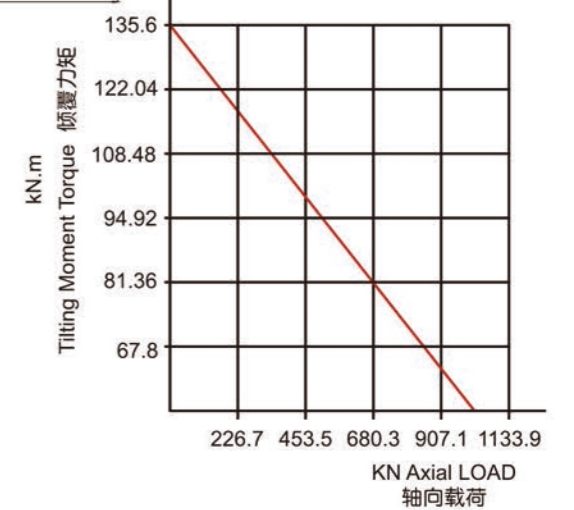

注意 Precautions: 蜗杆两端可根据客户要求非标准设计 “A、B” VIEW CUSTOMIZED ACCORDING TO REQUESTS

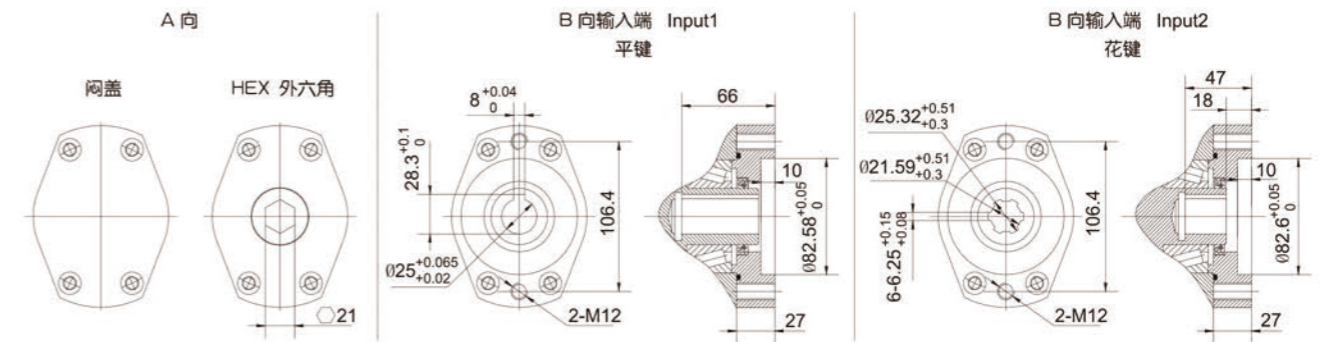

回转驱动性能参数表 Slewing Drive Performance Parameters

SDE17	10 KN.m	135.6 KN.m	73.2 KN.m	970 KN	390 KN	235 KN	205 KN	102 : 1	0.17° 0.09° 0.07° 0.05°	40%	200kg
	Output Torque 输出扭矩	Tilting Moment Torque 倾覆力矩	Holding Torque 保持力矩	Static Axial Rating 轴向静载荷	Static Radial Rating 径向静载荷	Dynamic Axial Rating 轴向动载荷	Dynamic Radial Rating 径向动载荷	Gear Ratio 减速比	Accuracy 精度	Efficiency 机械效率	Weight 重量

推杆 Screw Jack

特点 Features

- 定向定制 Customized Solutions
- 稳定可靠 Stable And Reliable



回转支承 Slewing Ring/ Bearing

